

Kood	Asva 600x600-70	Lehti	1
Jouko	Views	Merkkuri	1:50
Materiaali	70x135	Kaup.	25.10.2010
Jouko	K.Kahu	File	Asva 600x600-70.dwg



BlokhutWereld

www.blokhutwereld.nl

Legmeerdijk 276-6 1187NL Amstelveen

tel: 020 - 644 06 18 | fax: 020 - 203 10 88

Inuwtuin.nl www.inuwtuin.nl tel: 020 - 201 40 64

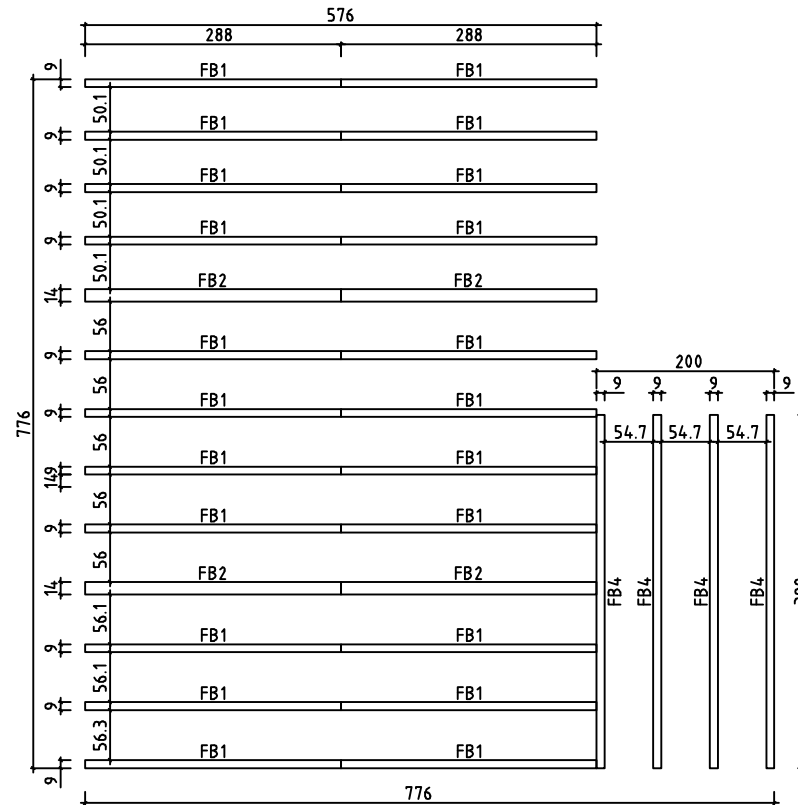

Kood	Asva 600x600-70	Laat	2
Joorn	Floorbeams (Impregnated)	Hoofkava	1:50
Materiaal	45x140;45x90	Koop	30.06.2010
Joornnaam	K.Kahu	File	Asva 600x600-70.dwg

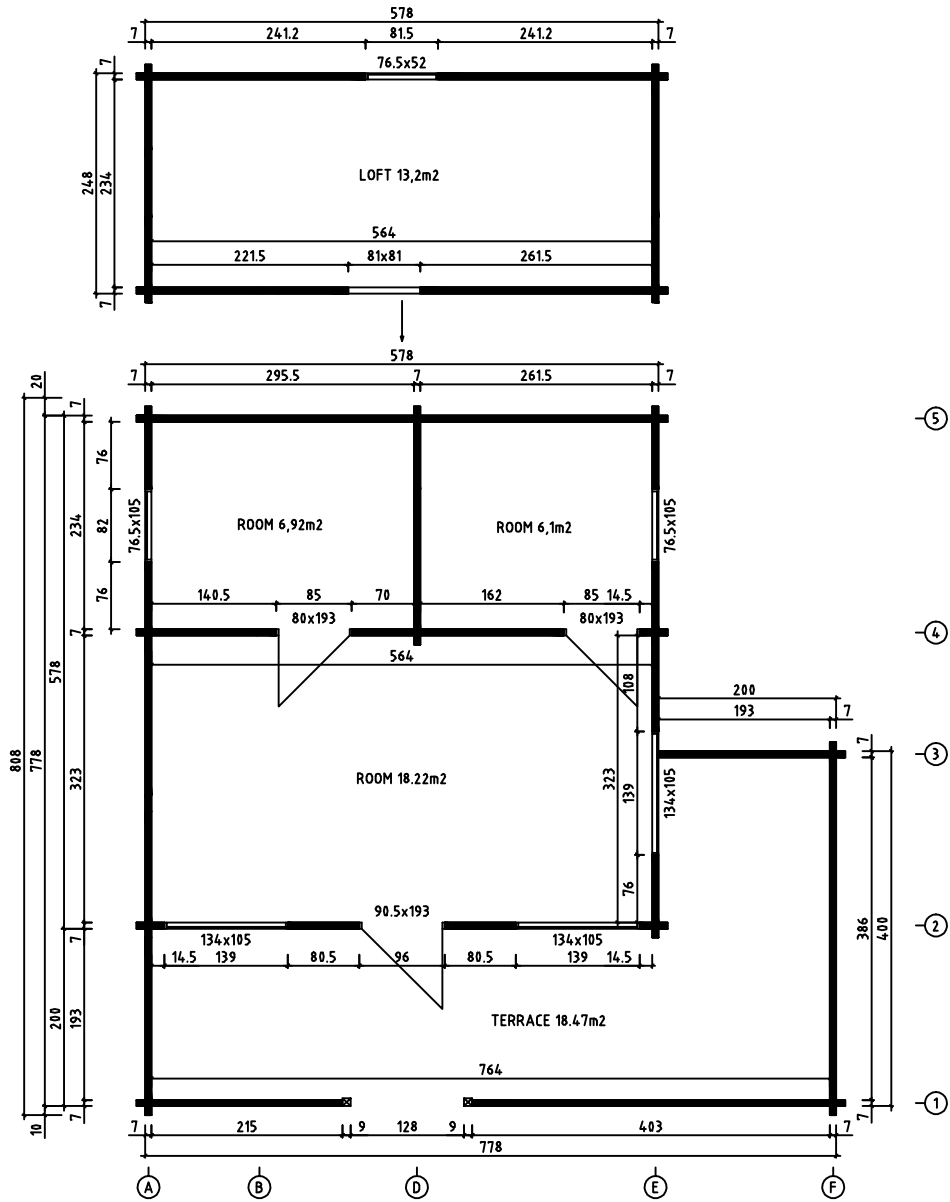

Kood	Asva 600x600-70	Leht	3
Juonin	Plan	Mastkava	1:50
Materiaali	70x135	Kaup.	30.06.2010
Juonesta	K.Kahu	File	Asva 600x600-70 Plan.dwg

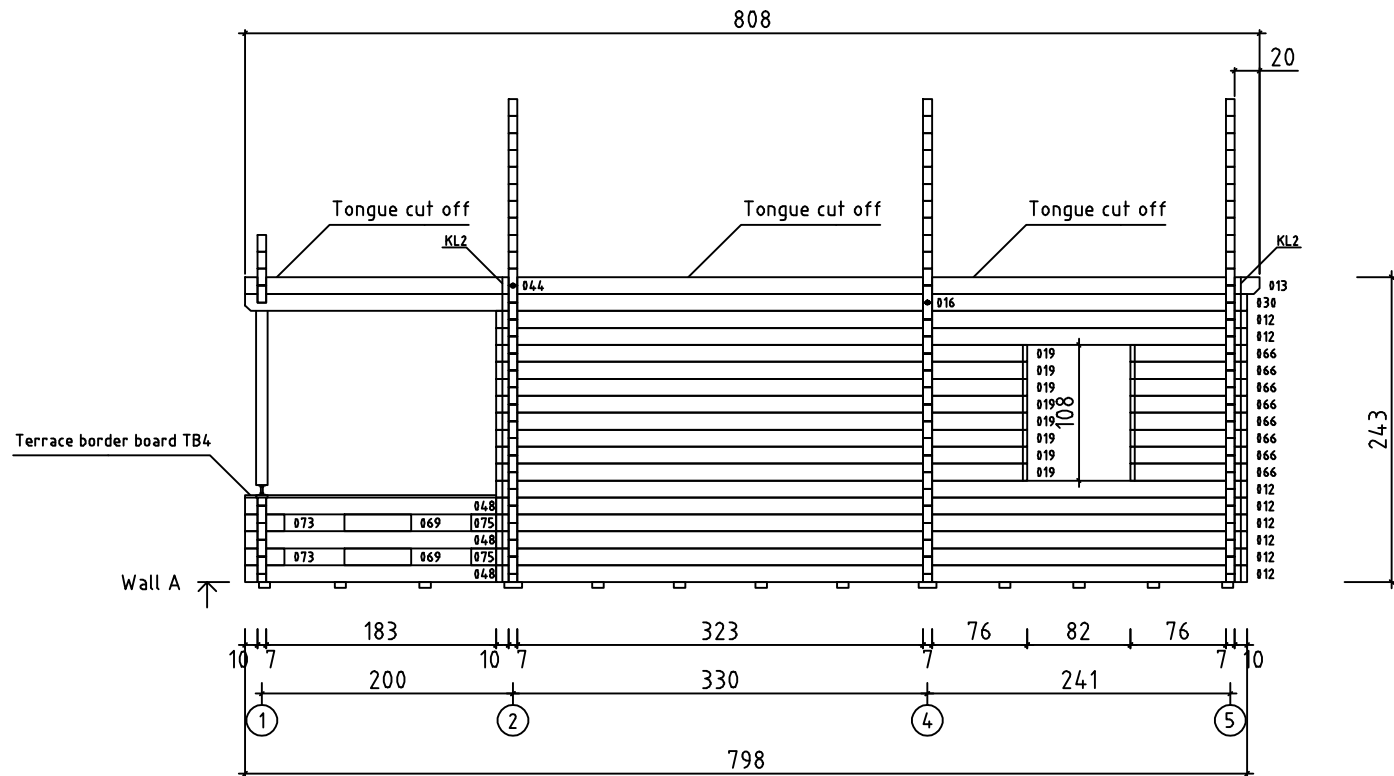

Kood	Asva 600x600-70	Leht	4
Joonis	Wall A	Mootkava	1:50
Materjal	7x13.5	Kuup.	30.06.2010
Joonestaj	K.Kahu	File	Asva 600x600-70.dwg

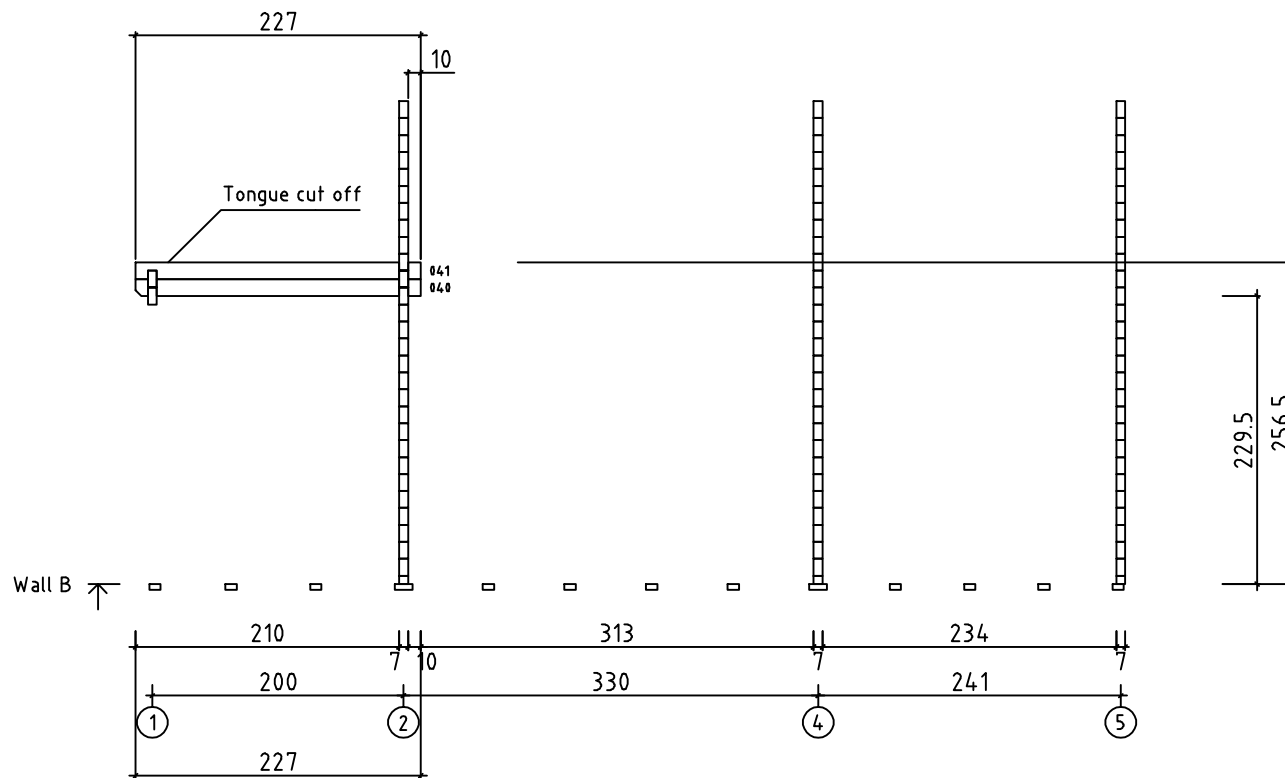

Kood	Asva 600x600-70	Leht	5
Joonis	Wall B	Mootkava	1:50
Materjal	7x13.5	Kuup.	30.06.2010
Joonestaj	K.Kahu	File	Asva 600x600-70.dwg

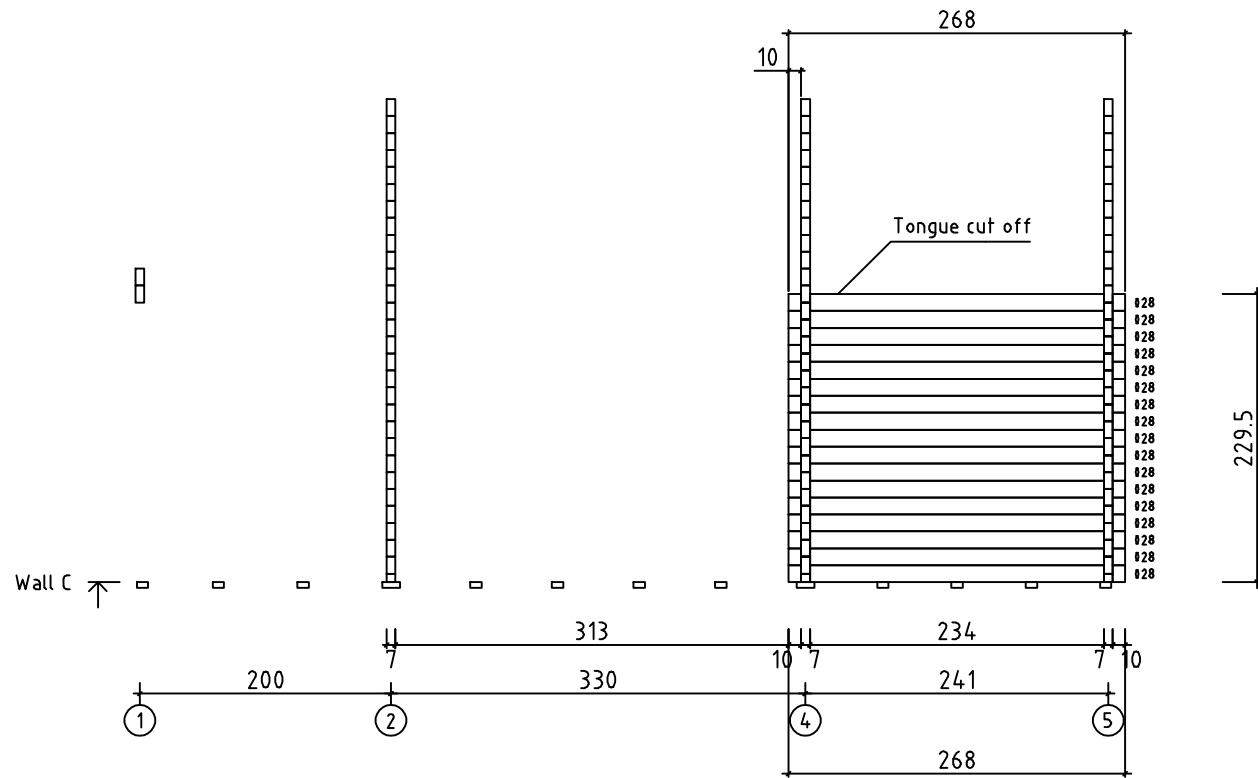

Kood	Asva 600x600-70	Leht	6
Joonis	Wall C	Mootkava	1:50
Materjal	7x13.5	Kuup.	30.06.2010
Joonestaj	K.Kahu	File	Asva 600x600-70.dwg

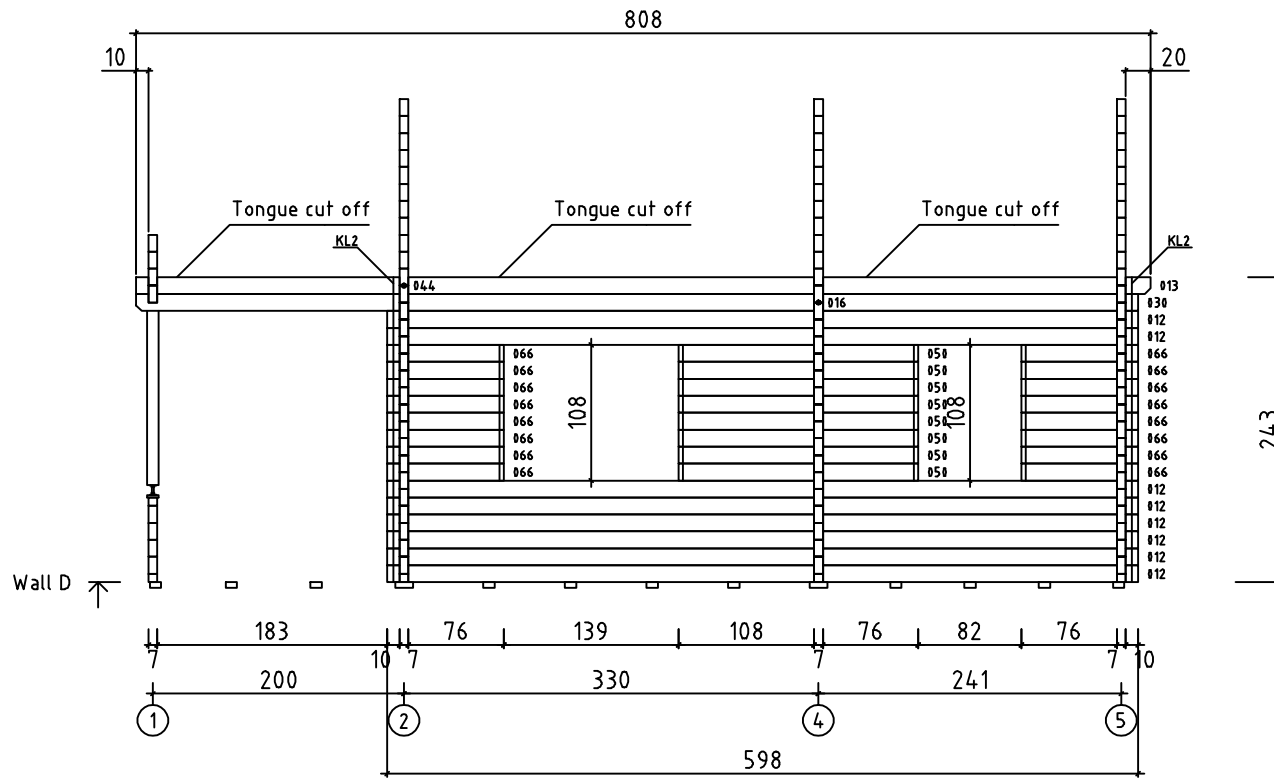

Kood	Asva 600x600-70	Leht	7
Joonis	Wall D	Mootkava	1:50
Materjal	7x13.5	Kuup.	30.06.2010
Joonestaj	K.Kahu	File	Asva 600x600-70.dwg

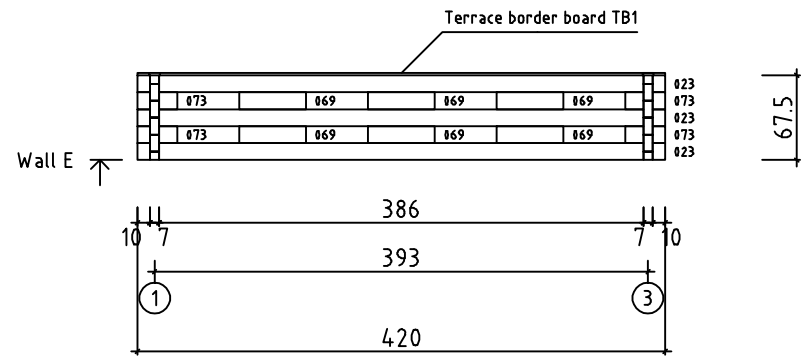

Kood	Asva 600x600-70	Leht	8
Joonis	Wall E	Muotkava	1:50
Materjal	7x13.5	Kuup.	30.06.2010
Joonestaj	K.Kahu	File	Asva 600x600-70.dwg

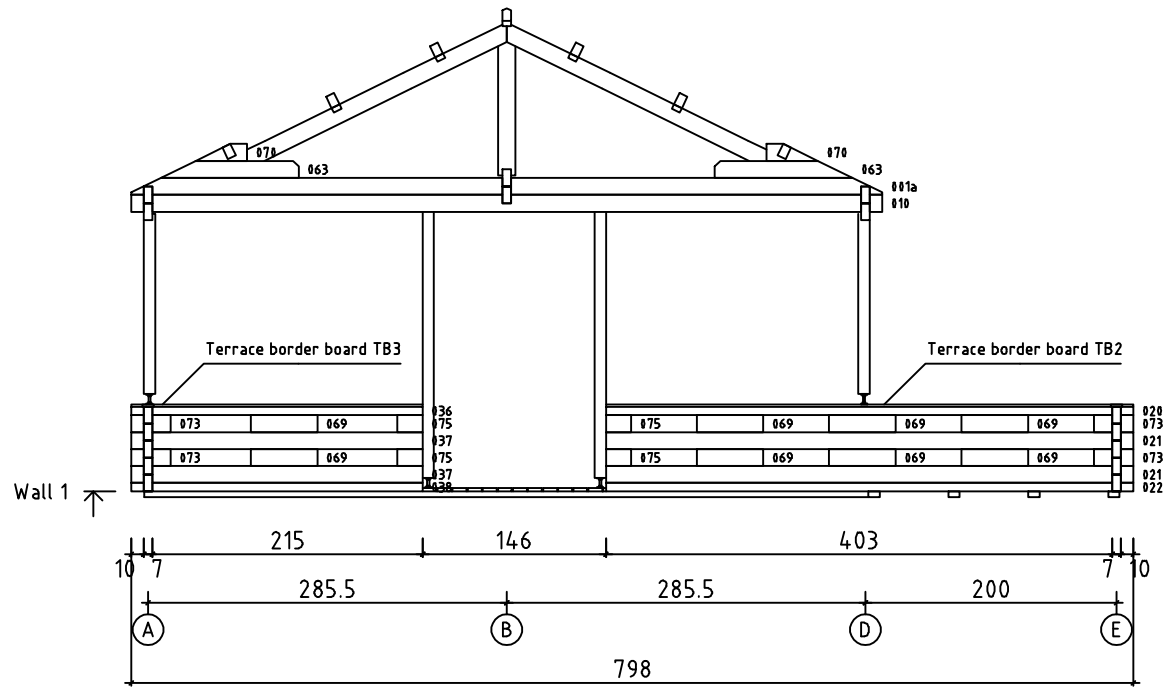

Kood	Asva 600x600-70	Leht	9
Joonis	Wall 1	Mootkava	1:50
Materjal	7x13.5	Kuup.	30.06.2010
Joonestaj	K.Kahu	File	Asva 600x600-70.dwg

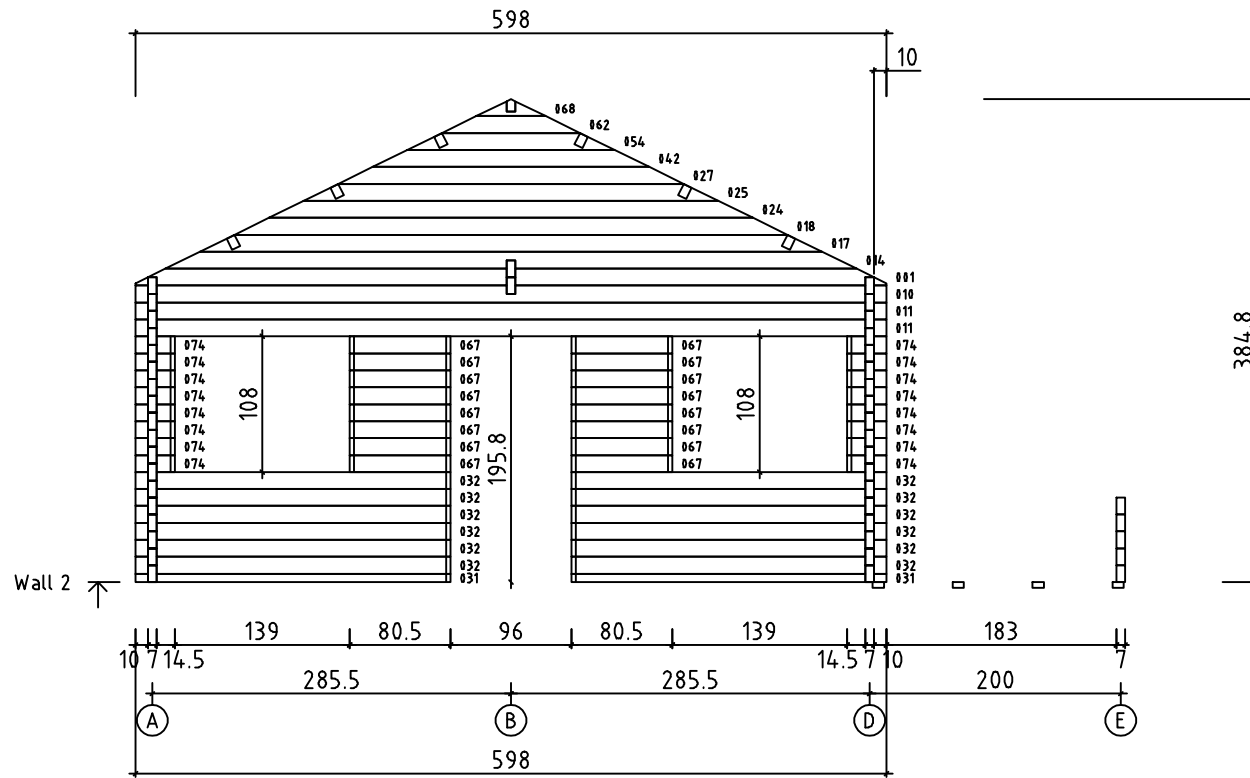

Kood	Asva 600x600-70	Leht	10
Joonis	Wall 2	Mootkava	1:50
Materjal	7x13.5	Kuup.	30.06.2010
Joonestaj	K.Kahu	File	Asva 600x600-70.dwg

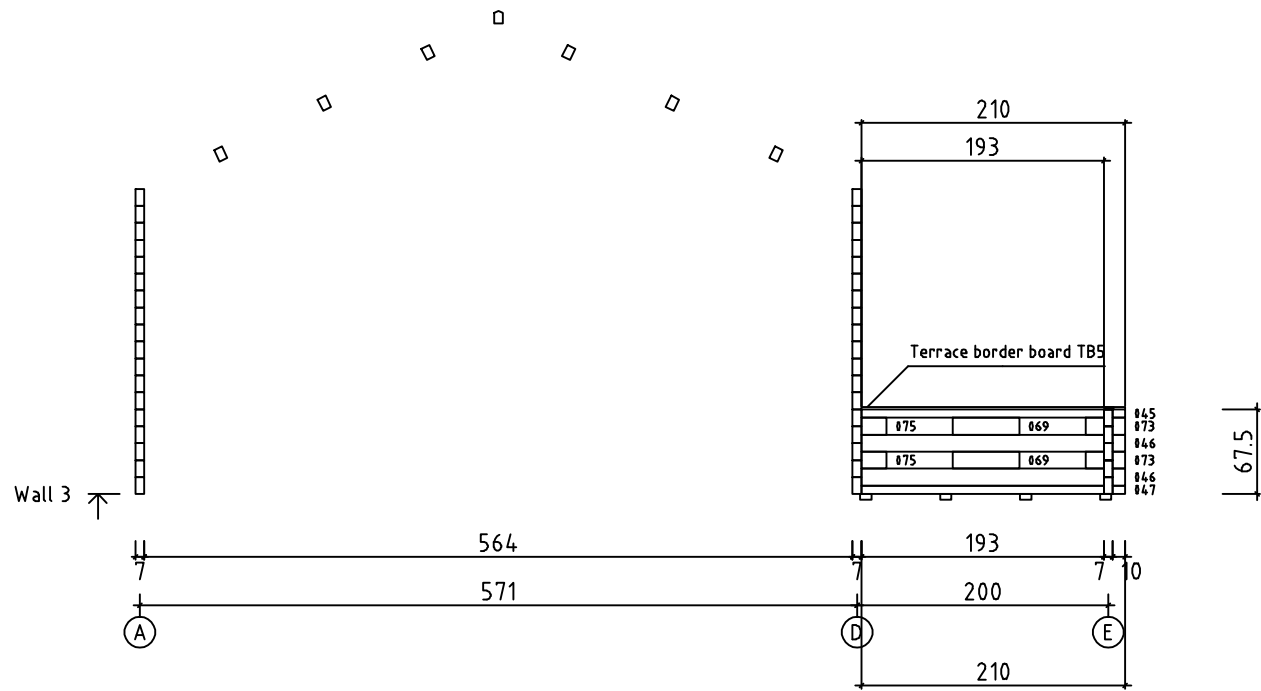

Kood	Asva 600x600-70	Leht	11
Joonis	Wall 3	Mootkava	1:50
Materjal	7x13.5	Kuup.	30.06.2010
Joonestaj	K.Kahu	File	Asva 600x600-70.dwg

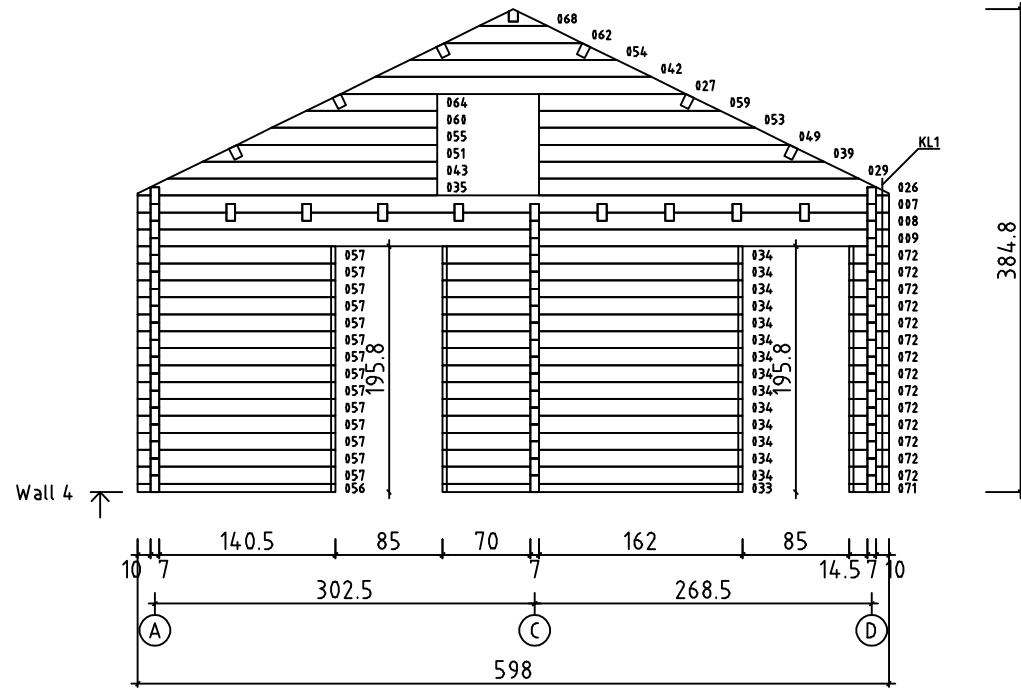

Kood	Asva 600x600-70	Leht	12
Joonis	Wall 4	Mootkava	1:50
Materjal	7x13.5	Kuup.	30.06.2010
Joonestas	K.Kahu	File	Asva 600x600-70.dwg

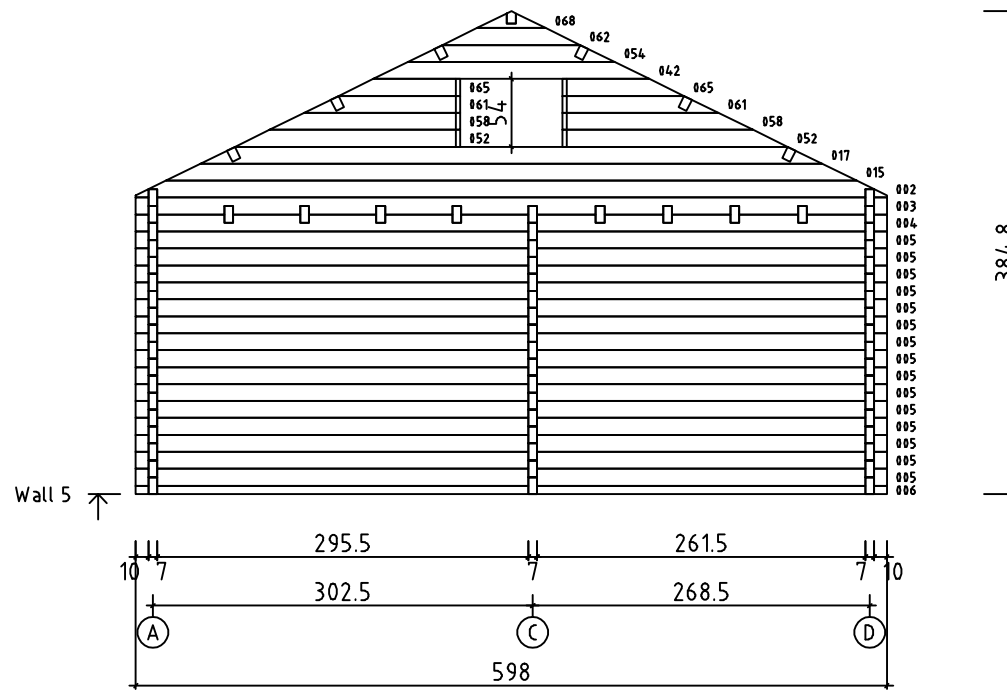

Kood	Asva 600x600-70	Leht	13
Joonis	Wall 5	Mootkava	1:50
Materjal	7x13.5	Kuup.	30.06.2010
Joonestaj	K.Kahu	File	Asva 600x600-70.dwg

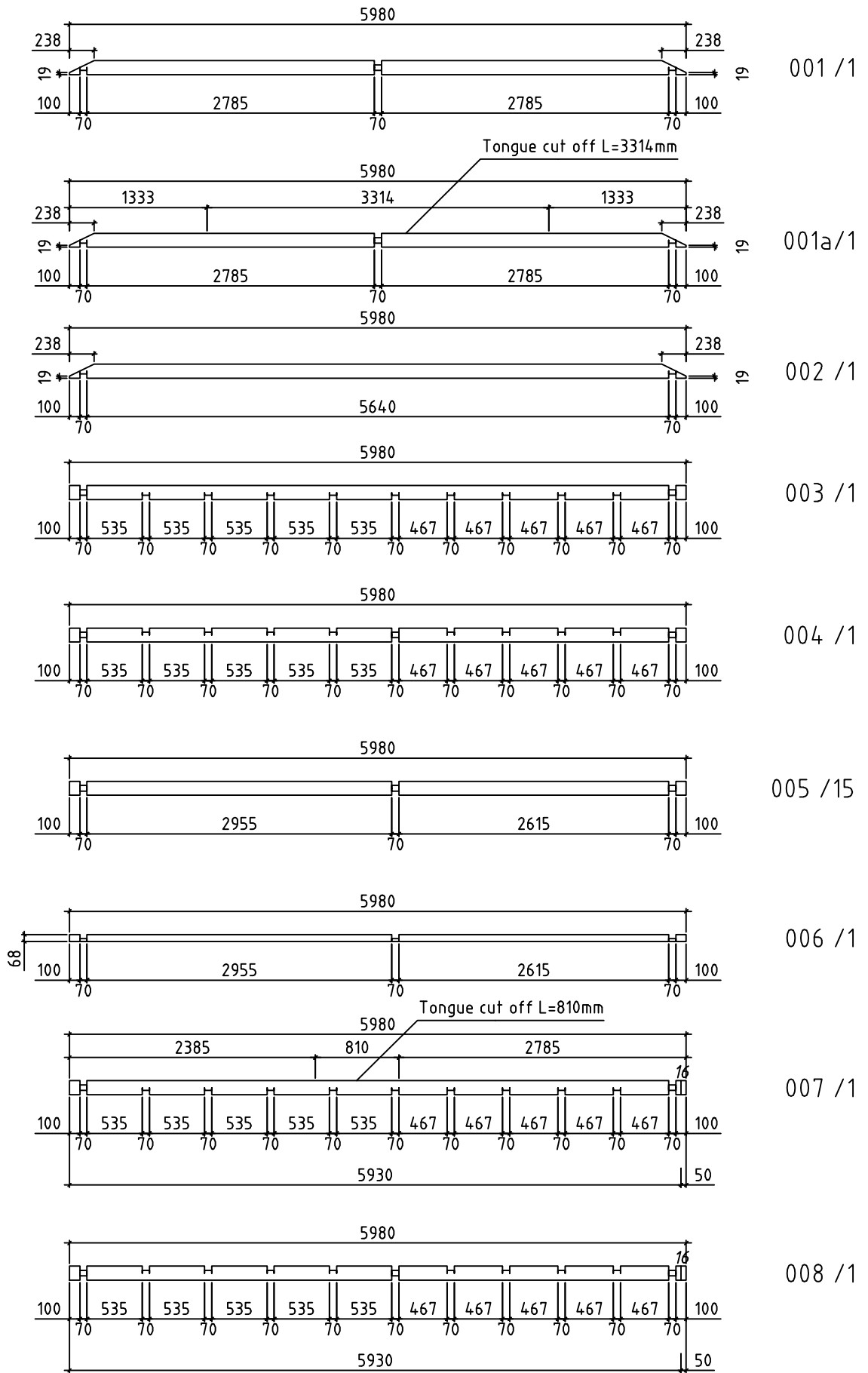

Kood	Asva 600x600-70	Materjal	70x135	File	Asva 600x600-70.dwg	Leht	1/16
------	-----------------	----------	--------	------	---------------------	------	------

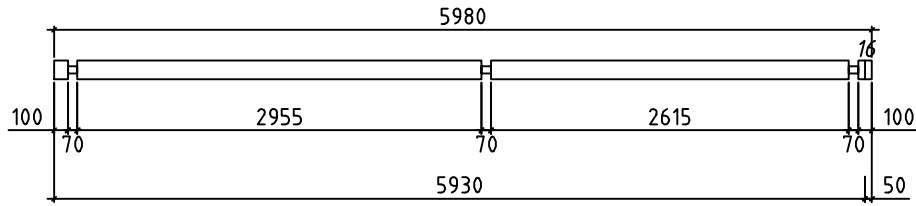

009 / 1

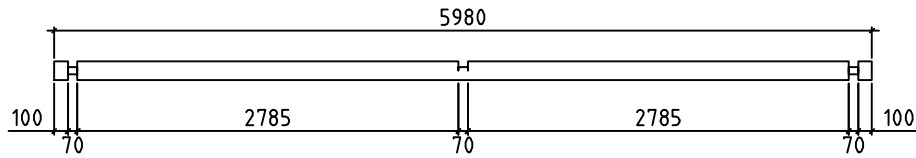

010 / 2

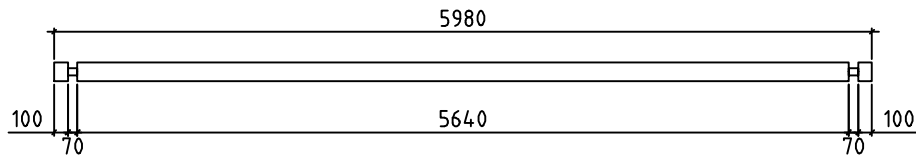

011 / 2

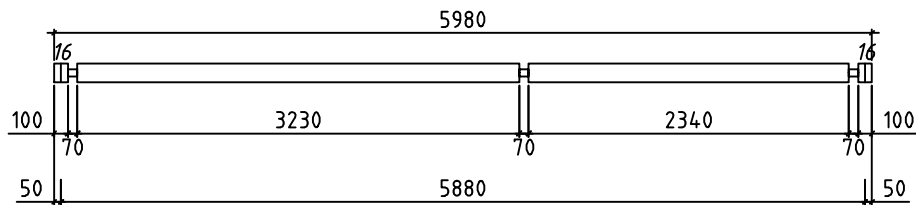

012 / 16

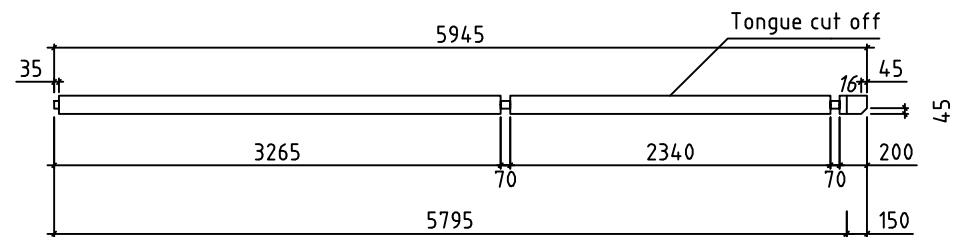

013 / 2

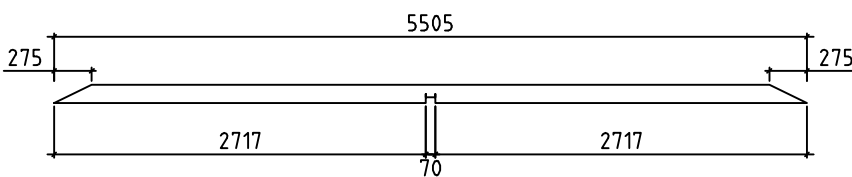

014 / 1

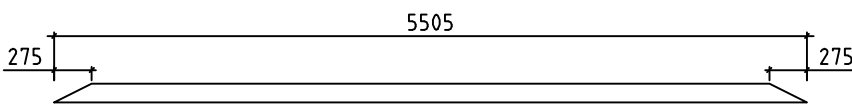

015 / 1

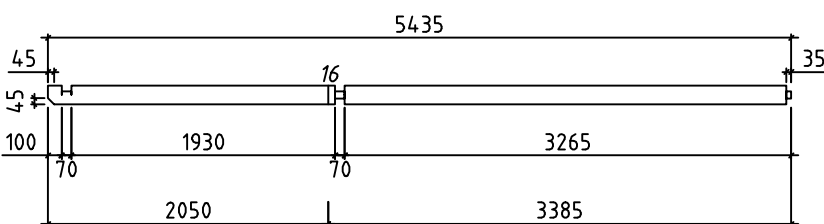

016 / 2

Kood	Asva 600x600-70	Materjal	70x135	File	Asva 600x600-70.dwg	Leht	2/16
------	-----------------	----------	--------	------	---------------------	------	------

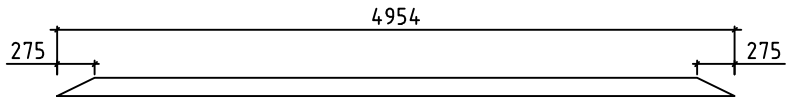

017 / 2

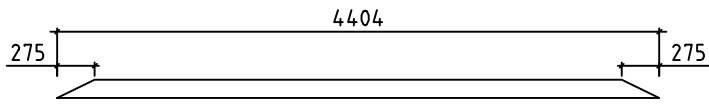

018 / 1

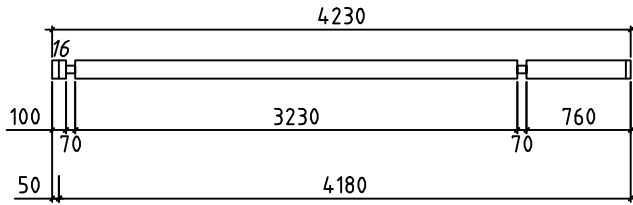

019 / 8

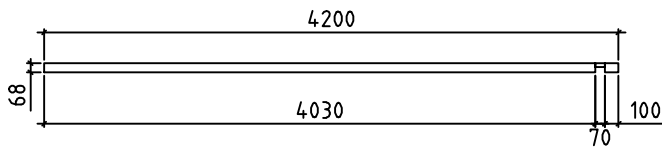

020 / 1

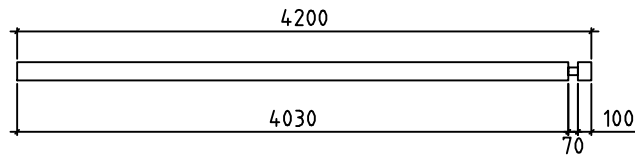

021 / 2

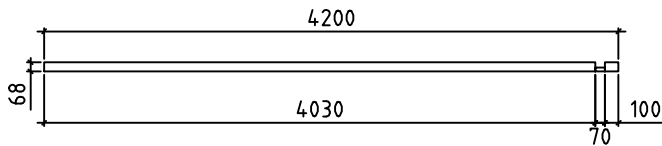

022 / 1

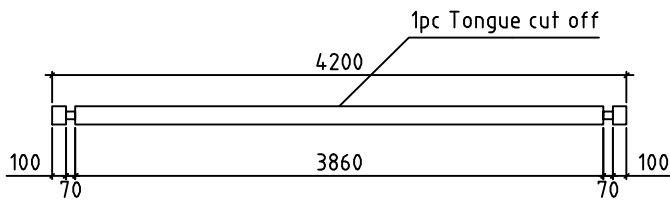

023 / 3

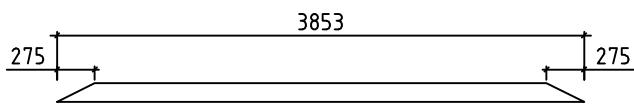

024 / 1

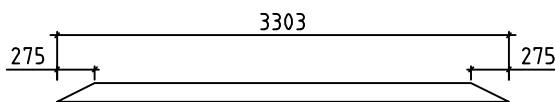

025 / 1

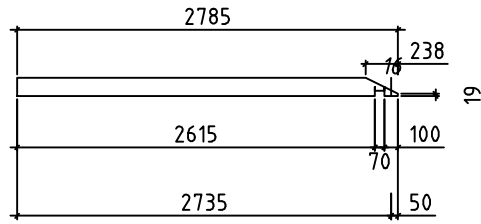

026 / 1

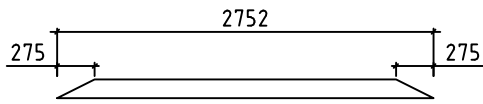

027 / 2

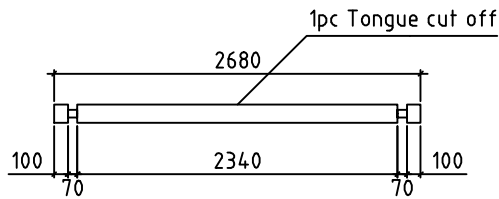

028 / 17

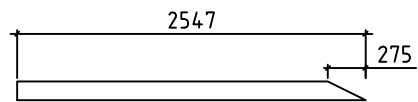

029 / 1

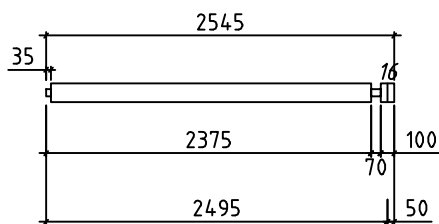

030 / 2

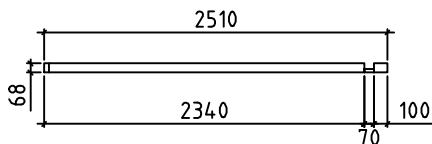

031 / 2

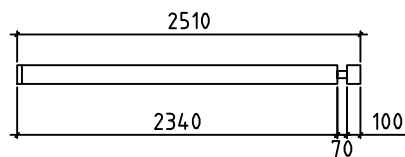

032 / 12

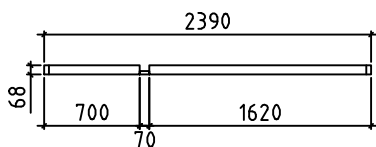

033 / 1

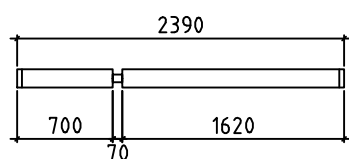

034 / 14

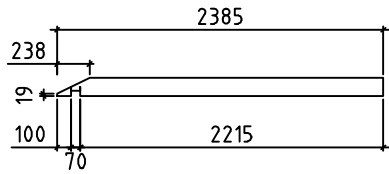

035 /1

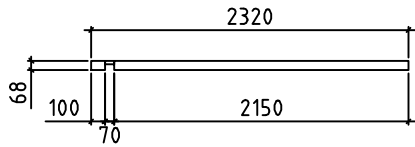

036 /1

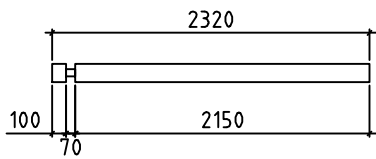

037 /2

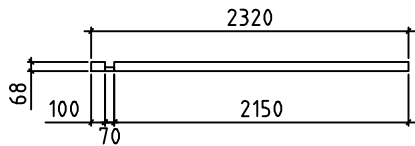

038 /1

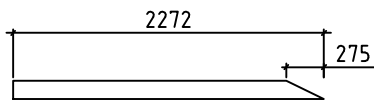

039 /1

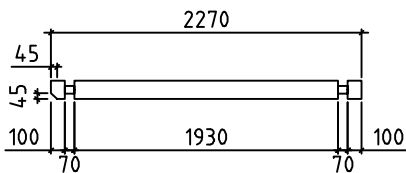

040 /1

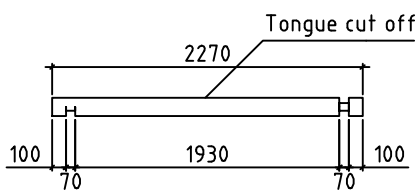

041 /1

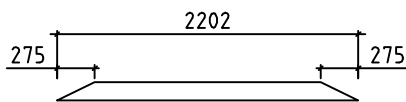

042 /3

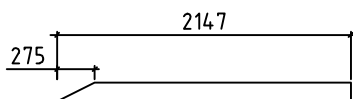

043 /1

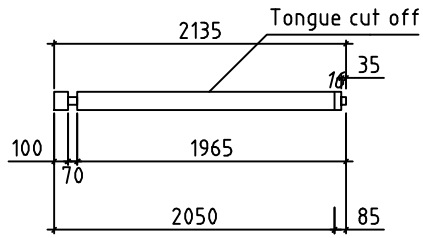

044 / 2

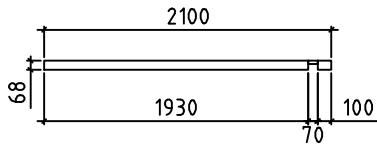

045 / 1

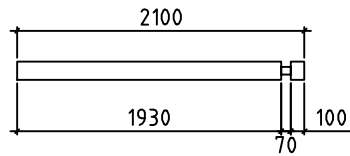

046 / 2

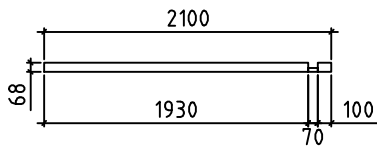

047 / 1

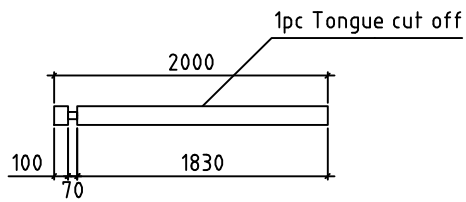

048 / 3

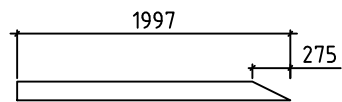

049 / 1

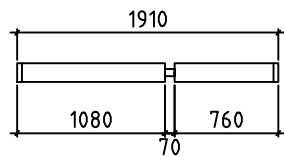

050 / 8

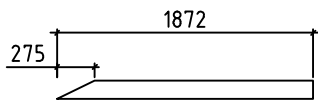

051 / 1

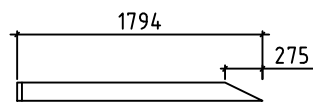

052 / 2

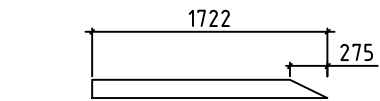

053 /1

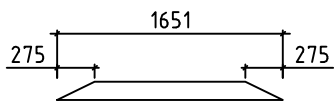

054 /3

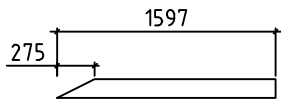

055 /1

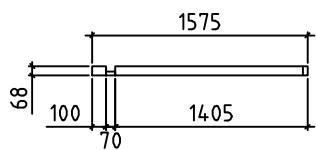

056 /1

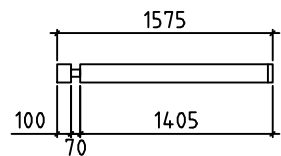

057 /14

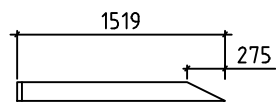

058 /2

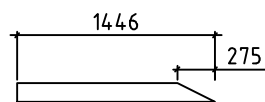

059 /1

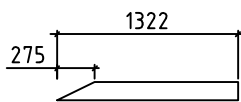

060 /1

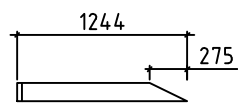

061 /2

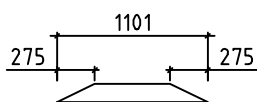

062 /3

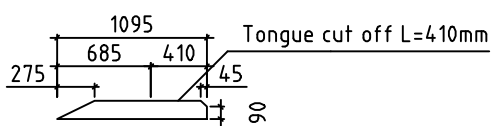

063 /2

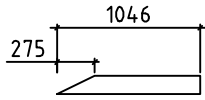

064 / 1

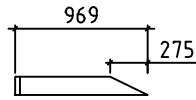

065 / 2

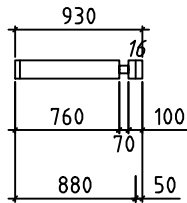

066 / 24

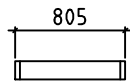

067 / 16

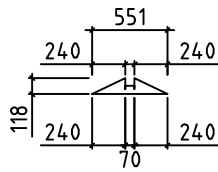

068 / 3



069 / 18

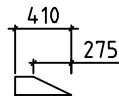

070 / 2

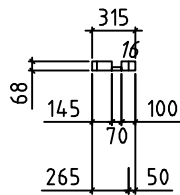

071 / 1

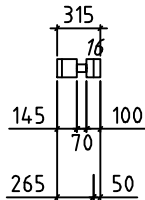

072 / 14

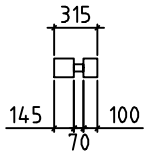

073 /12

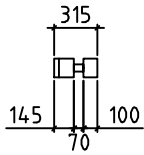

074 /16



075 /8

CEILING BEAM (70x135)

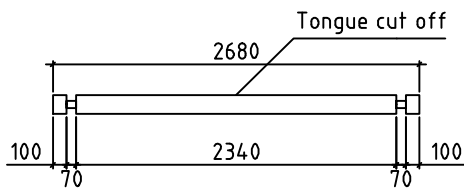

CB1 /8

RAFTER SUPPORTING POST 70x140x1065 1pc

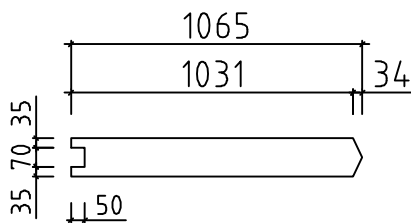

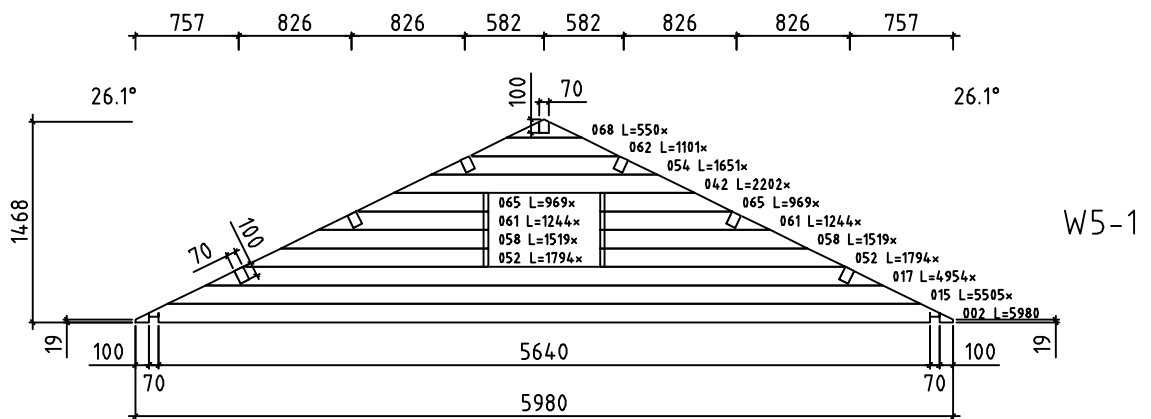
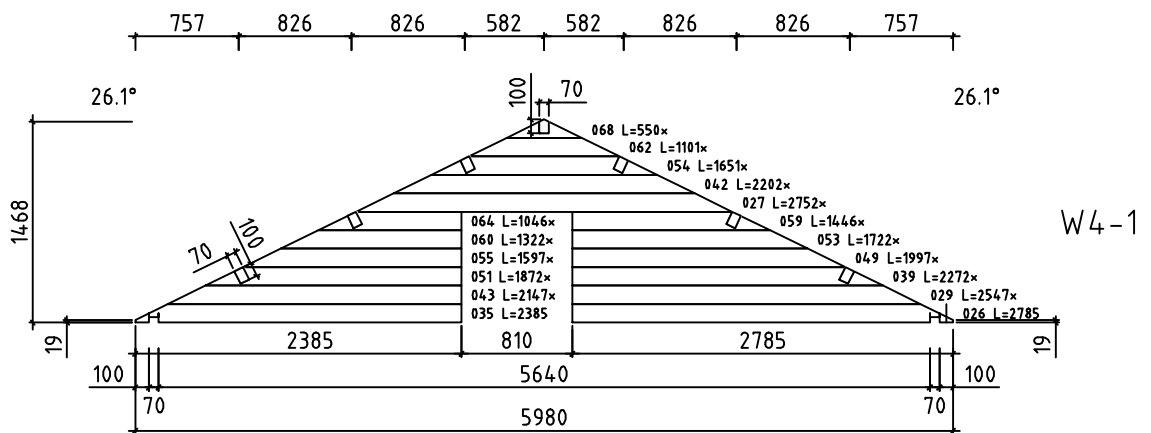
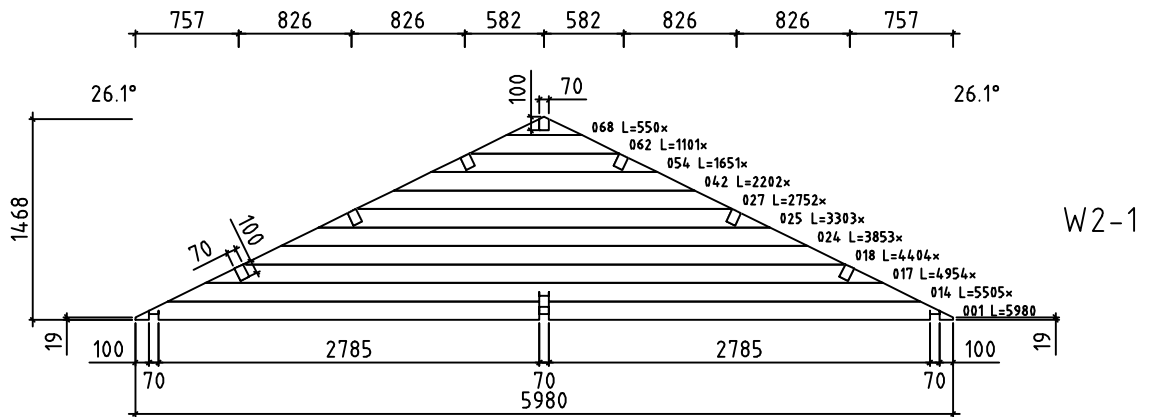
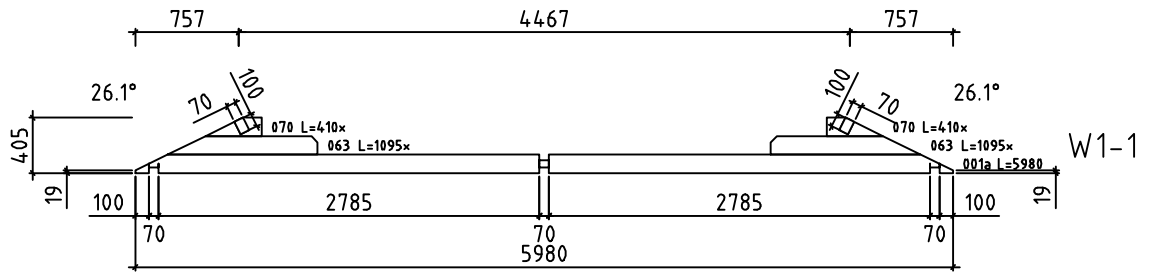

Kood	Asva 600x600-70	Materjal	70x135	File	Asva 600x600-70.dwg	Leht	10/16
------	-----------------	----------	--------	------	---------------------	------	-------

FLOORBEAMS(IMPREGNATED)

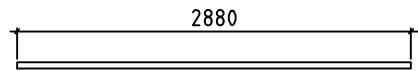

FB2 /4
140x45

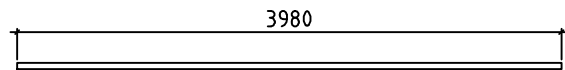

FB3 /4
90x45

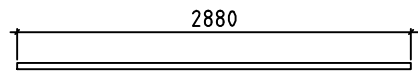

FB1 /22
90x45

PURLINS

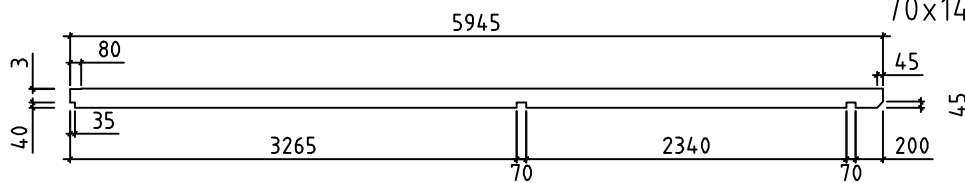

PR2 /6
70x140(70x100)

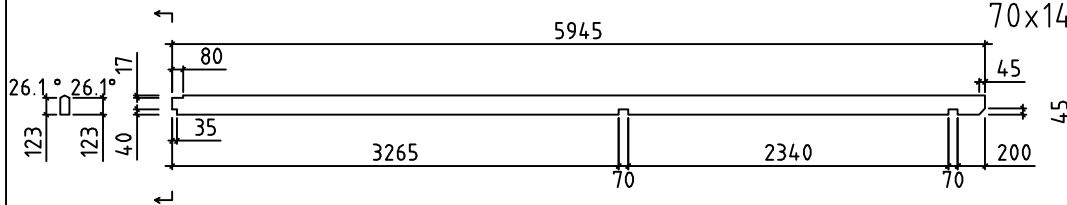

PR1 /1
70x140(70x100)

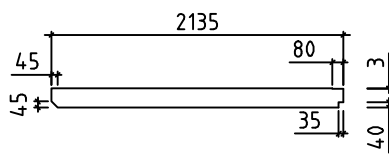

PR4 /4
70x140

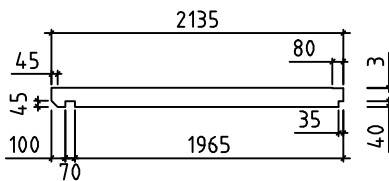

PR5 /2
70x140(70x100)

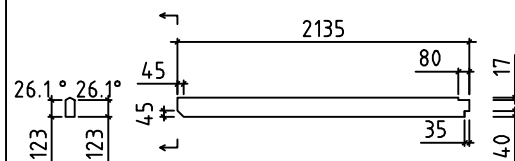

PR3 /1
70x140

Kood	Asva 600x600-70	Materjal	File	Asva 600x600-70.dwg	Leht	11/16
------	-----------------	----------	------	---------------------	------	-------

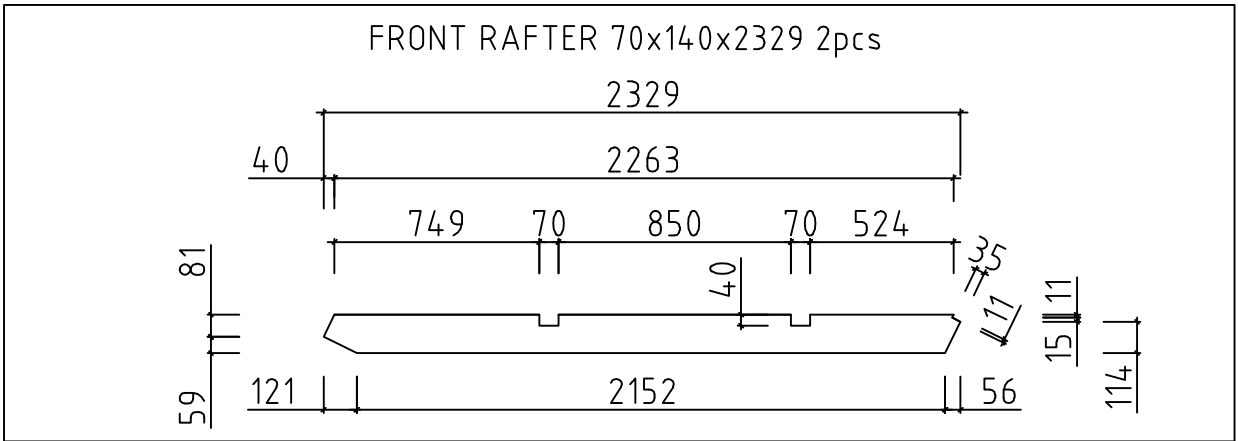

TERRACE FIXING BOARD 19x90

675mm 2pcs

TERRACE FIXING SLAT 30x40

675mm 2pcs

SLEEPING FLOOR FIXING SLAT 30x40

2340mm 2pcs

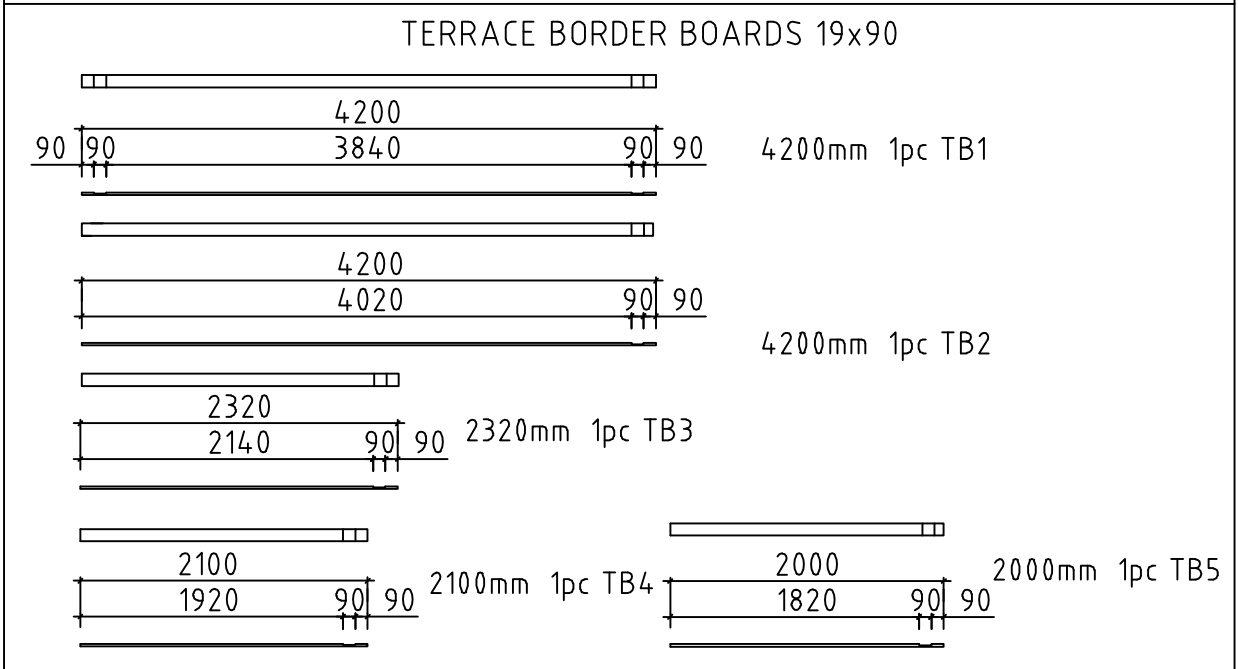
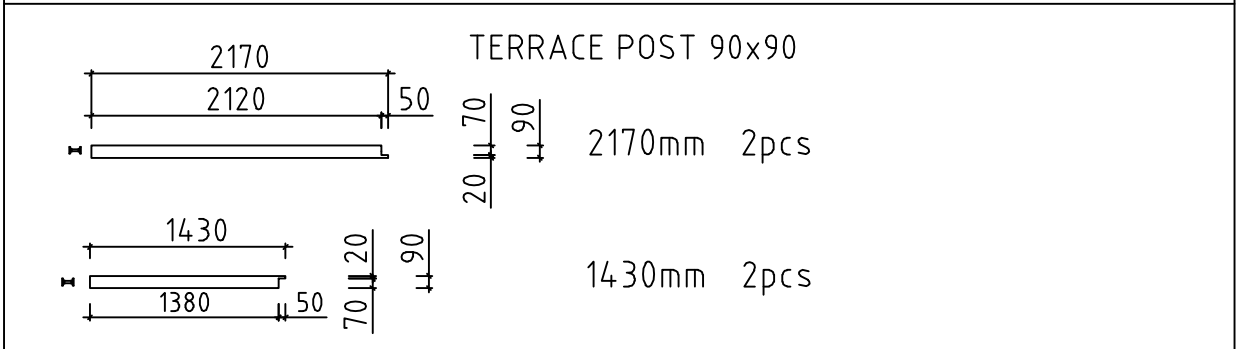

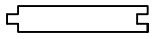
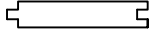
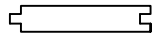
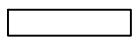
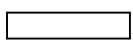
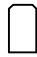
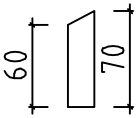
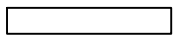
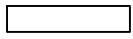
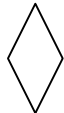
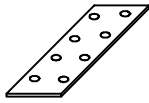
	<p>FLOORBOARD 28x...</p> <p>3220 mm 2330 mm</p>	<p>covers 5.64m covers 5.57m</p>	
	<p>ROOFBOARD 19x...</p> <p>1980 mm 1570 mm</p>	<p>covers 2x8.08m covers 2x8.08m</p>	
	<p>SLEEPING FLOOR 19x...</p> <p>3230 mm 2400 mm</p>	<p>covers 2.34m covers 2.34m</p>	
	<p>TERRACE BOARD 28x110 Impregnated (space between boards 10mm)</p> <p>1990 mm 1920 mm</p>	<p>13pcs 68pcs</p>	
	<p>EAVE BOARD 19x90</p> <p>4040 mm</p>	<p>4pcs</p>	
	<p>SKIRTING SLAT 19x35</p> <p>58 m.l. for floor</p>		
	<p>SIDEWALL SKIRTING SLAT 19x70</p> <p>3230 mm 2610 mm 2100 mm</p>	<p>2pcs 2pcs 2pcs</p>	
	<p>GABLE BOARD 19x90</p> <p>3600 mm</p>	<p>4pcs</p>	
	<p>BOARD MATCHING WITH GABLE BOARD 19x90</p> <p>3600 mm</p>	<p>4pcs</p>	
	<p>DECORATION</p>	<p>2pcs</p>	
	<p>STEEL PLATES TO CONNECT PURLINS</p> <p>60x160</p>	<p>7pcs</p>	
<p>Kood Asva 600x600-70</p>	<p>Materjal</p>	<p>File Asva 600x600-70.dwg</p>	<p>Leht 13/16</p>

1340x1050 - 3 set

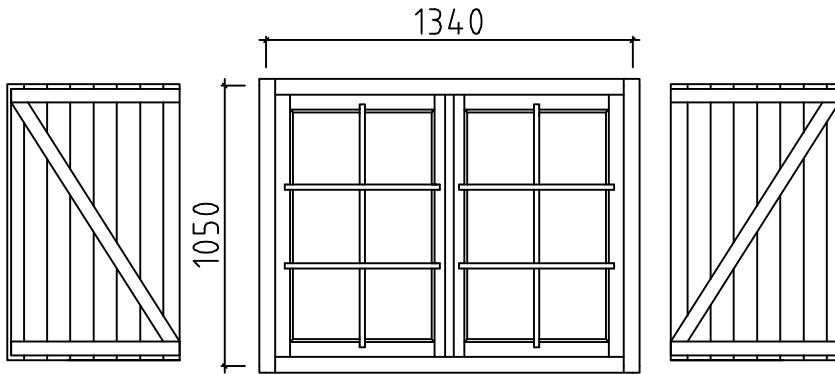

Border boards 19x70

1470mm 4pcs
1290mm 4pcs
1100mm 8pcs

Tenon boards 19x70

1050mm 4pcs
Tenon slat 19x25
1050mm 4pcs

765x1050 - 2 set left side

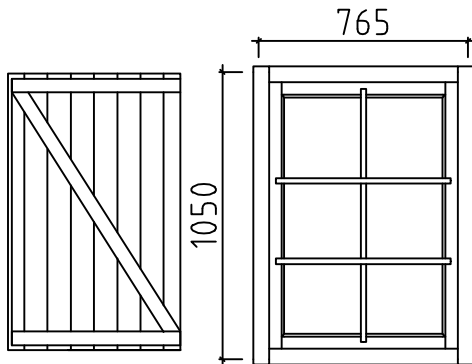

Border boards 19x70

900mm 6pcs
1100mm 12pcs
715mm 6pcs

Tenon boards 19x70

1050mm 6pcs
Tenon slat 19x25
1050mm 6pcs

765x520 - 1 set left side

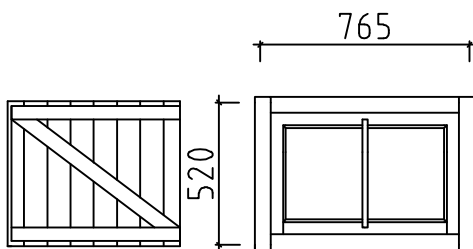

Border boards 19x70

900mm 2pcs
715mm 2pcs
570mm 4pcs

Tenon boards 19x70

520mm 2pcs
Tenon slat 19x25
520mm 2pcs

Frame around sleeping floor entrance 790x790 - 1 set

Border boards 19x70

920mm 2pcs
840mm 4pcs
740mm 2pcs

905x1930 - 1pc right side

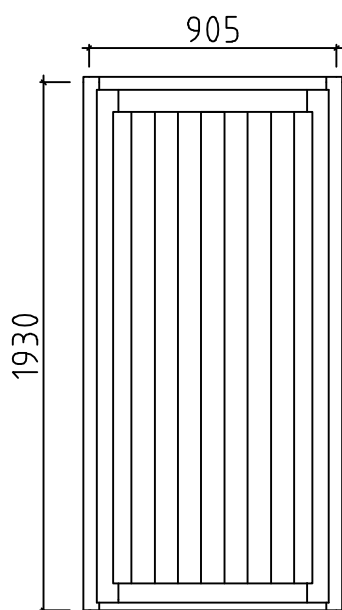

Border boards 19x70

1880mm 4pcs

1035mm 2pcs

Tenon boards 19x70

1930mm 2pcs

Tenon slat 19x25

1930mm 2pcs

800x1930 - 2pcs (1left; 1right side)

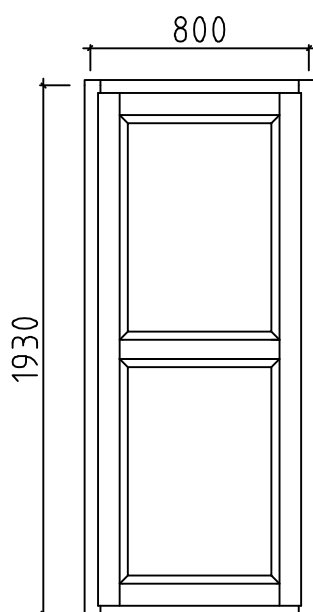

Border boards 19x70

1880mm 8pcs

930mm 4pcs

Tenon boards 19x70

1930mm 4pcs

Tenon slat 19x25

1930mm 4pcs

LADDER 490x2540

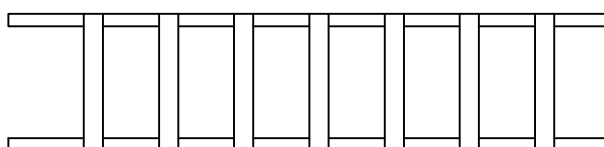

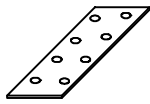

Steel plates to connect purlins

60x160 7pcs

SCREW JOINTS M10

2460mm

5pcs

12,3m



NUT M10
10 pcs



WASHER M10
10 pcs

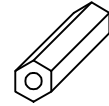

SPLICE NUT M10
5 pcs

DOOR-WINDOW ASSEMBLING

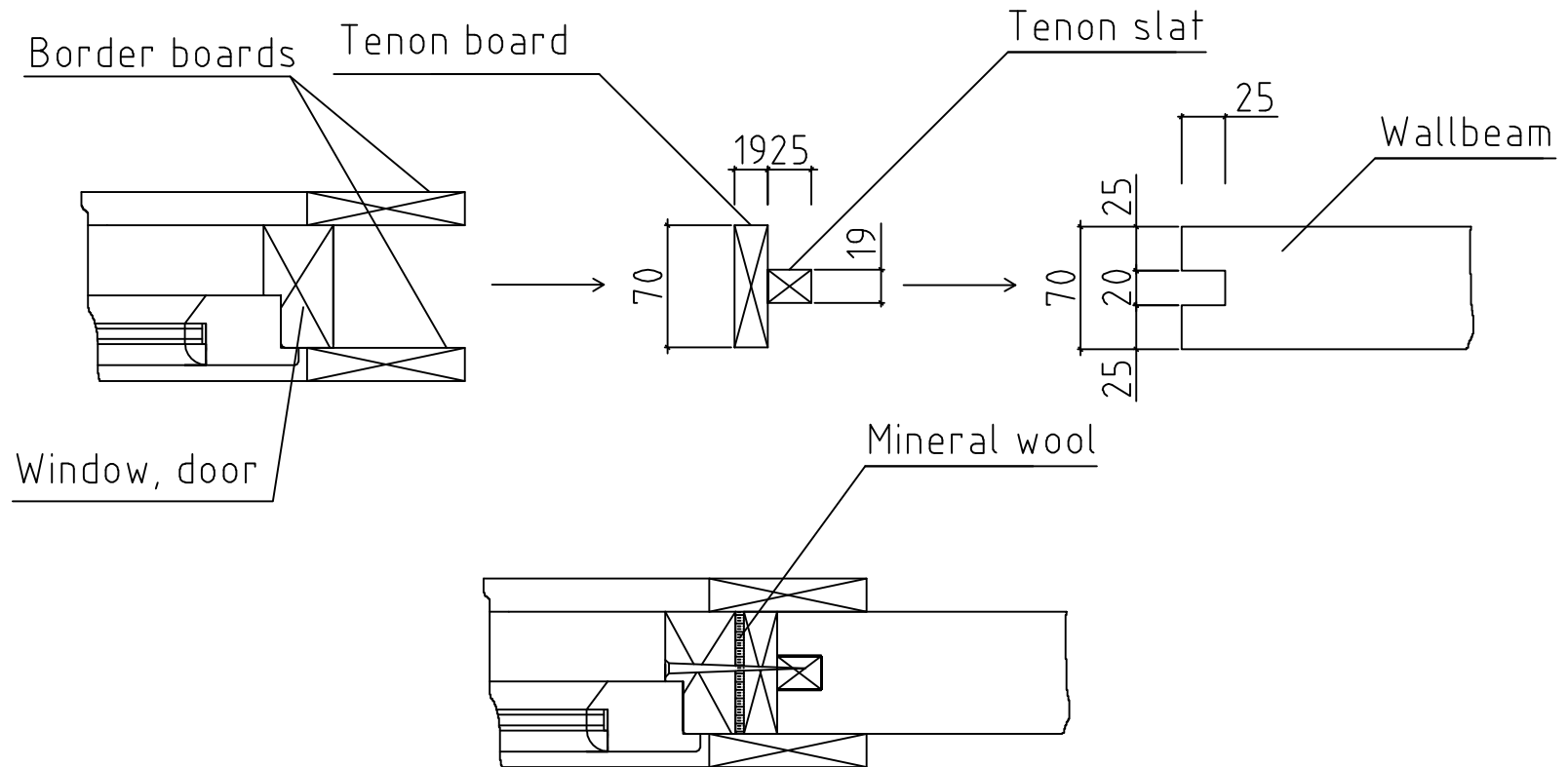

NB!!! Use mineral wool for isolation around the window and door.
(isolating foam is not allowed)

NB!!! Dont screw tenon slat and board into wallbeam.

NB!!! Fix window and door into tenon slat & board (like on the drawing)