

Kood	Material	File	Leht
001 / 1	9.2x16	TSSMONDO.dwg	1/23
002 / 2	9.2x16	TSSMONDO.dwg	1/23
003 / 2	9.2x16	TSSMONDO.dwg	1/23
003A / 1	9.2x16	TSSMONDO.dwg	1/23
004 / 10	9.2x16	TSSMONDO.dwg	1/23
005 / 2	9.2x16	TSSMONDO.dwg	1/23
006 / 1	9.2x16	TSSMONDO.dwg	1/23
007 / 5	9.2x16	TSSMONDO.dwg	1/23

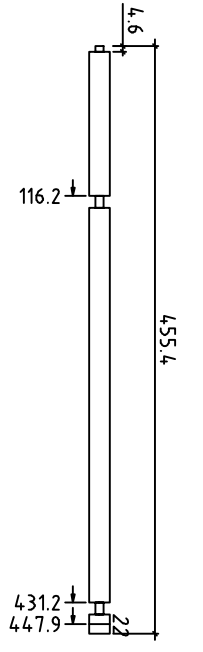

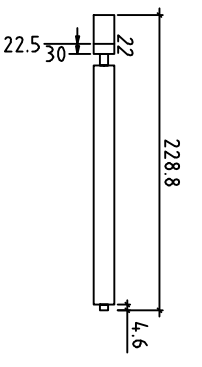

Kood	Material	File	Leht
077 /5	9.2x16	TSSMONDO.dwg	10/23

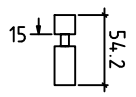
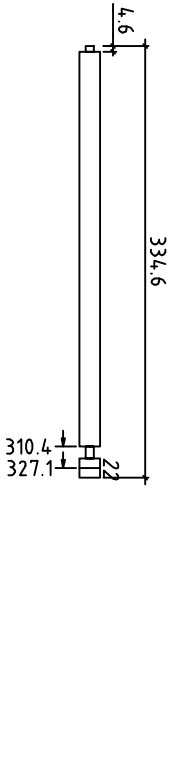
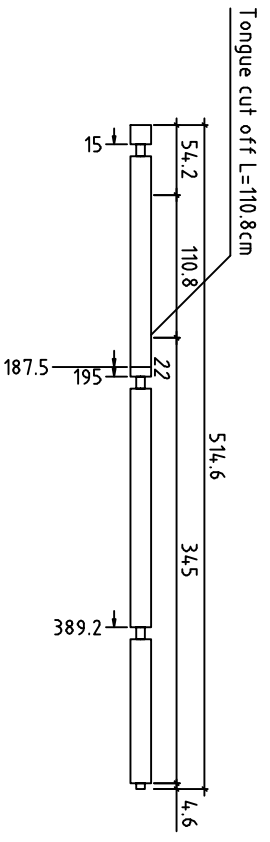
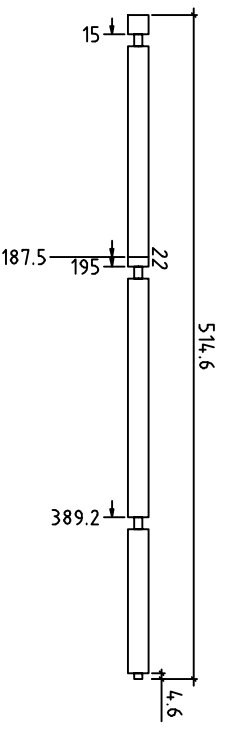
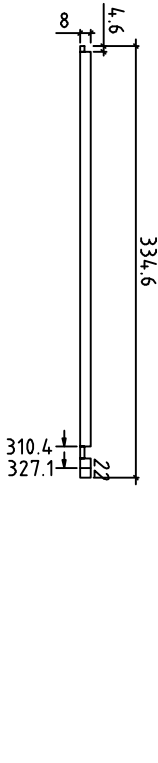
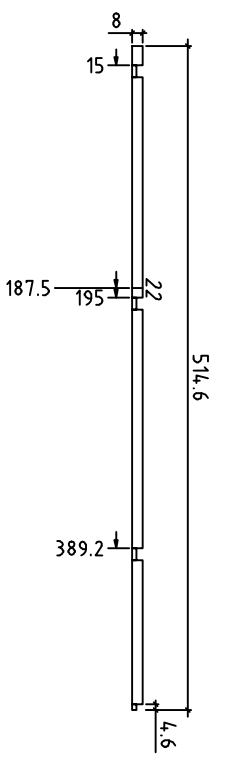
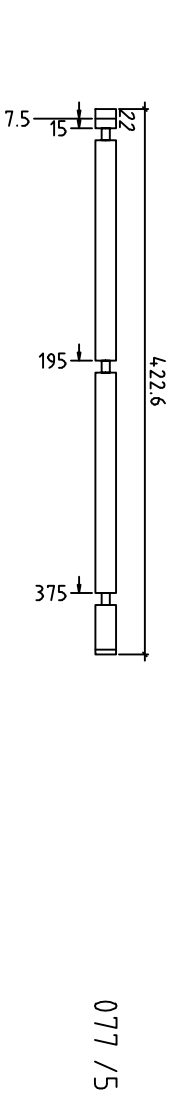
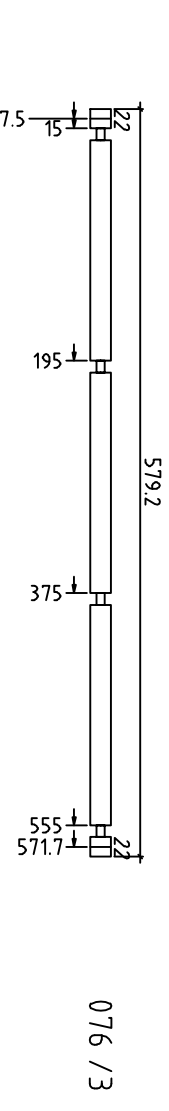
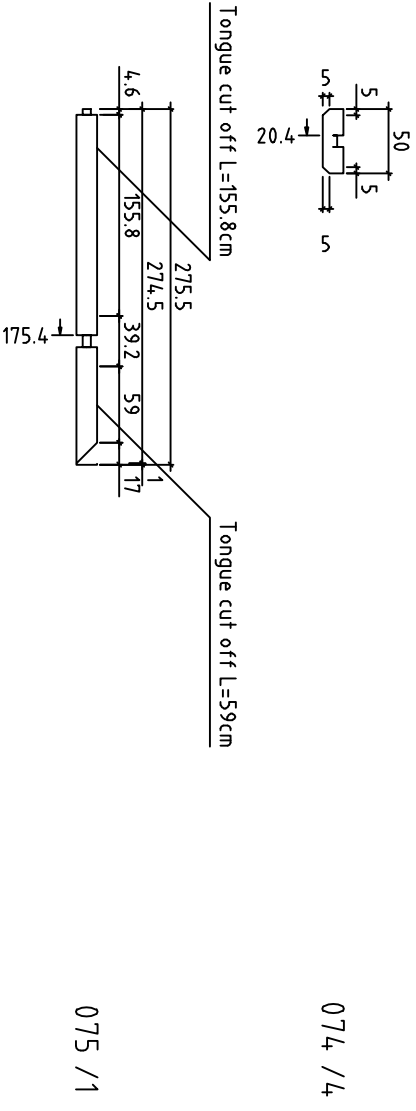
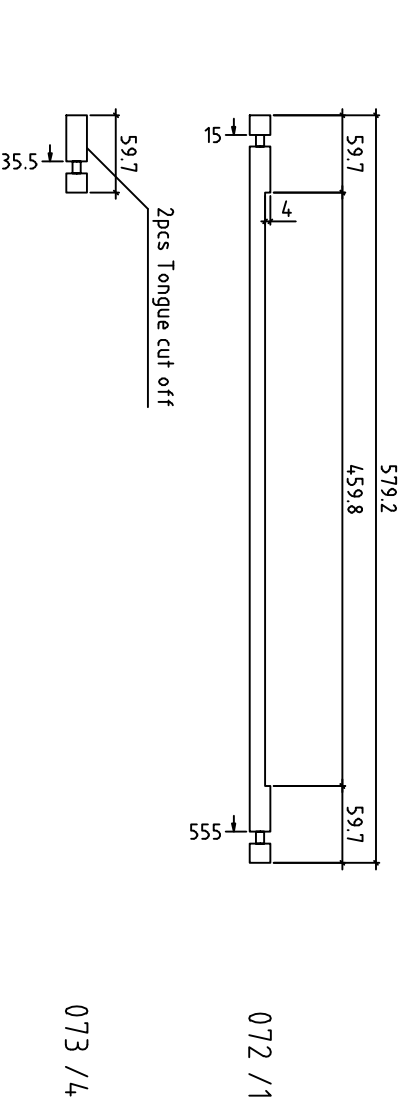
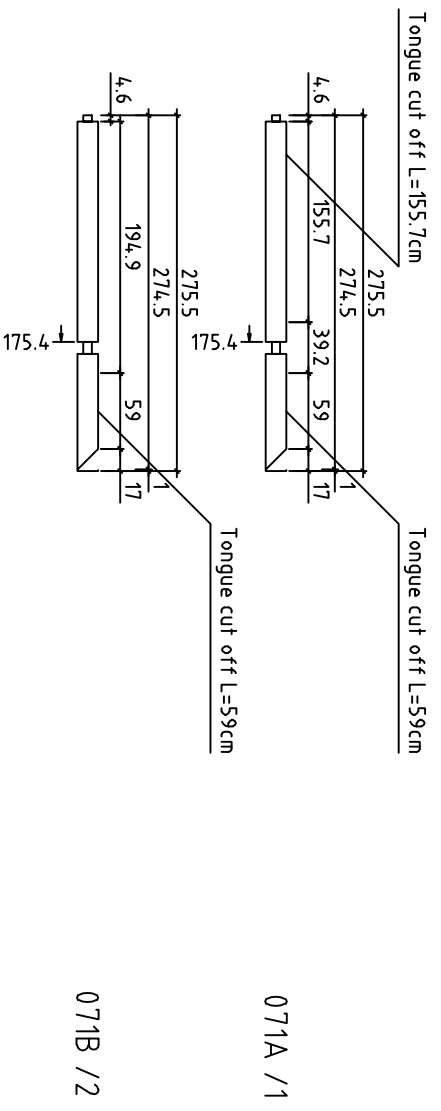
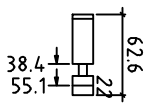

078 /13

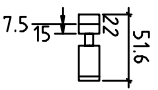

079 /8

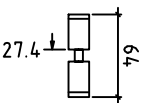

080 /8

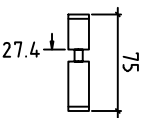

081 /8

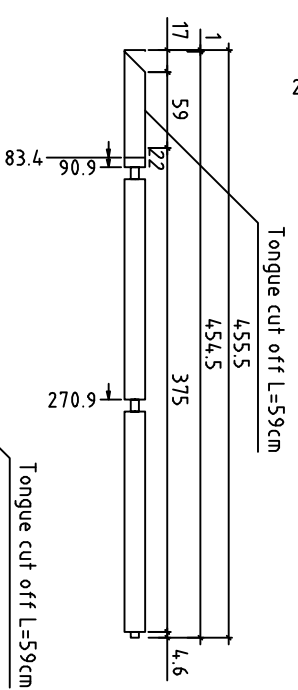

082 /1

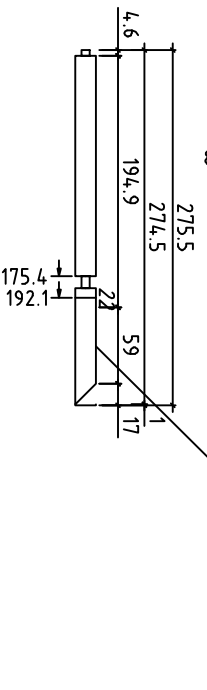

083 /1

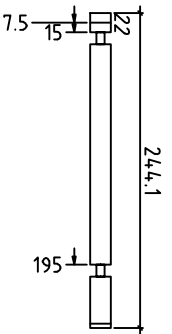

084 /3

Kood

Materjal

9.2x16

File

TSSMONDO.dwg

Leht

11/23

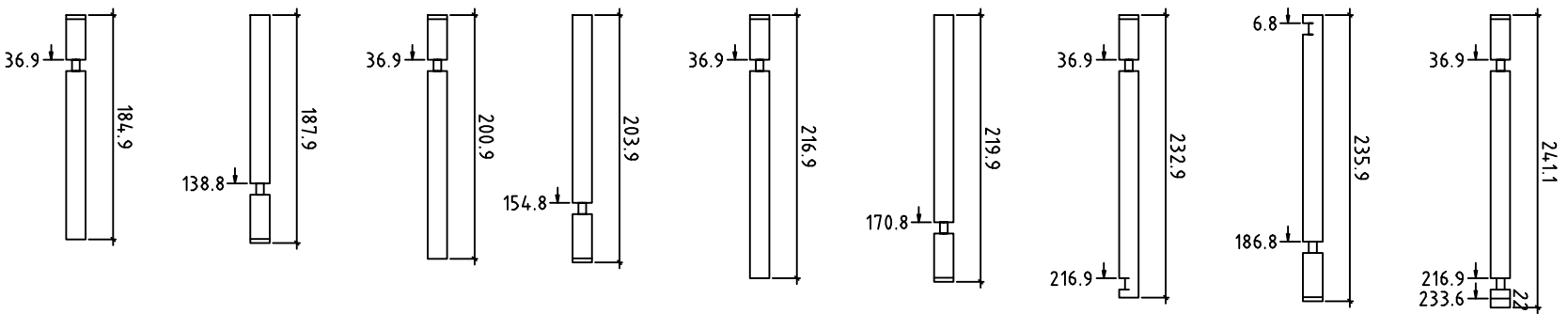

Kood

Material

9.2x16

File

TSSMONDO.dwg

Leht

12/23

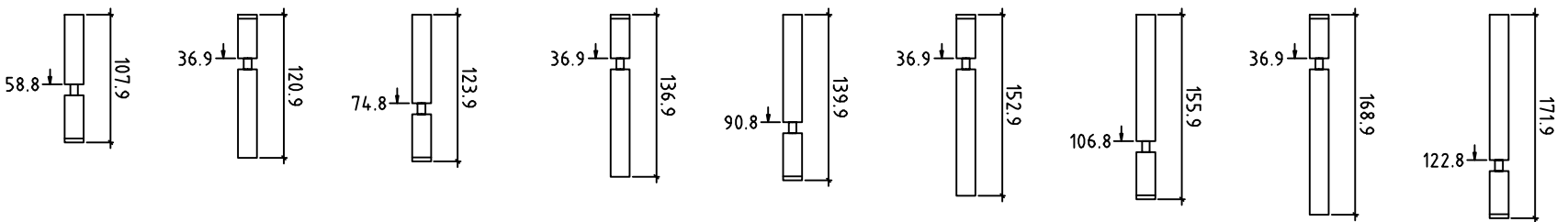

094 /2

095 /2

096 /2

097 /2

098 /2

099 /2

100 /2

101 /2

102 /2

Kood

Materjal

9.2x16

File

TSSMONDO.dwg

Leht

13/23

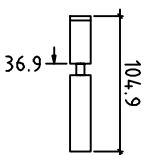
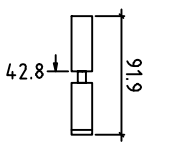
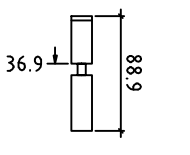
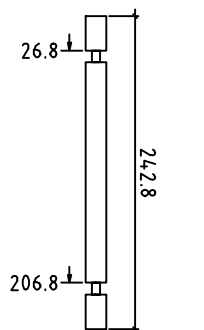
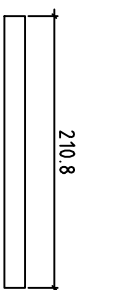
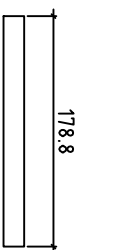
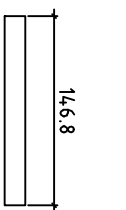
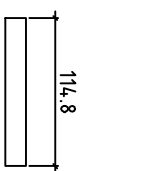
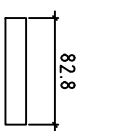
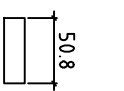
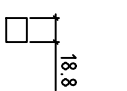
	103 /2
	104 /2
	105 /2
	106 /2
	107 /3
	108 /3
	109 /2
	110 /2
	111 /2
	112 /2
	113 /2

Kood

Materjal

9.2x16

File

TSSMONDO.dwg

Leht

14./23

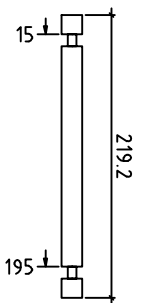

114 /15

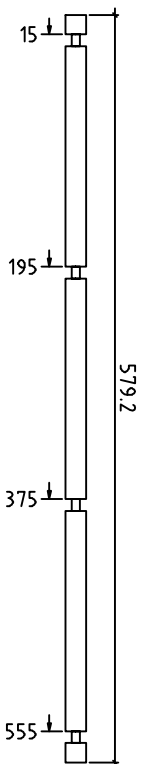

115 /14

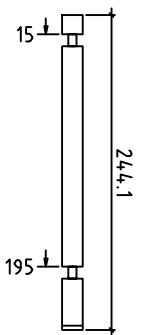

116 /3

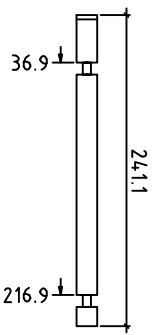

117 /3

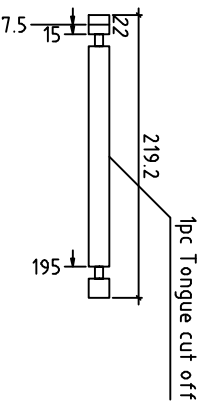

118 /17

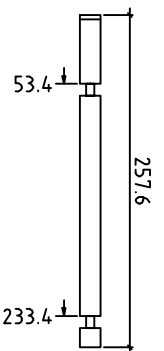

119 /12

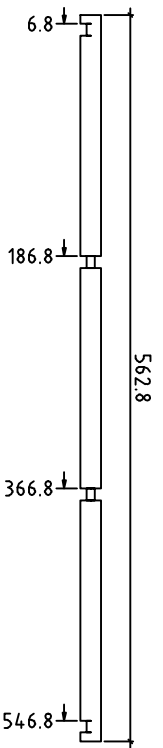

120 /1

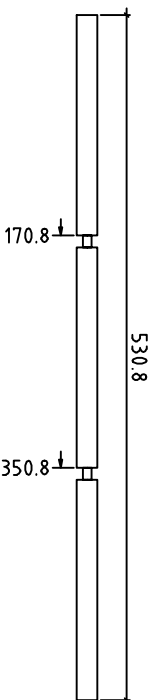

121 /1

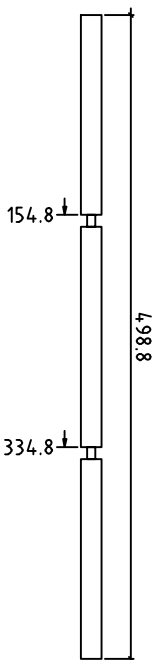

122 /1

Kood	Materiaal	File	Leht
	9.2x16	TSSMONDO.dwg	15/23

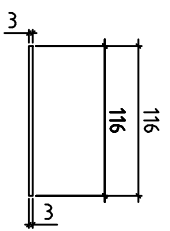
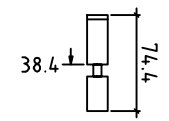
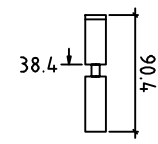
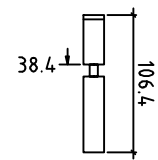
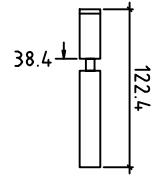
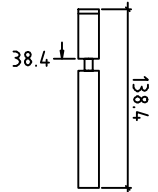
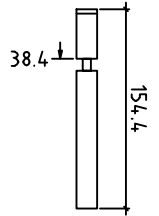
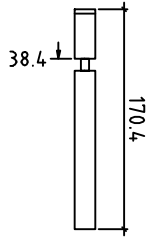
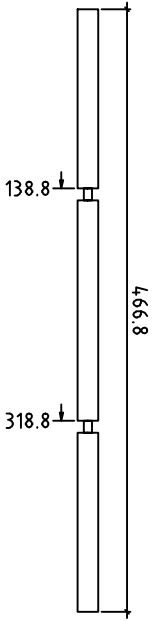
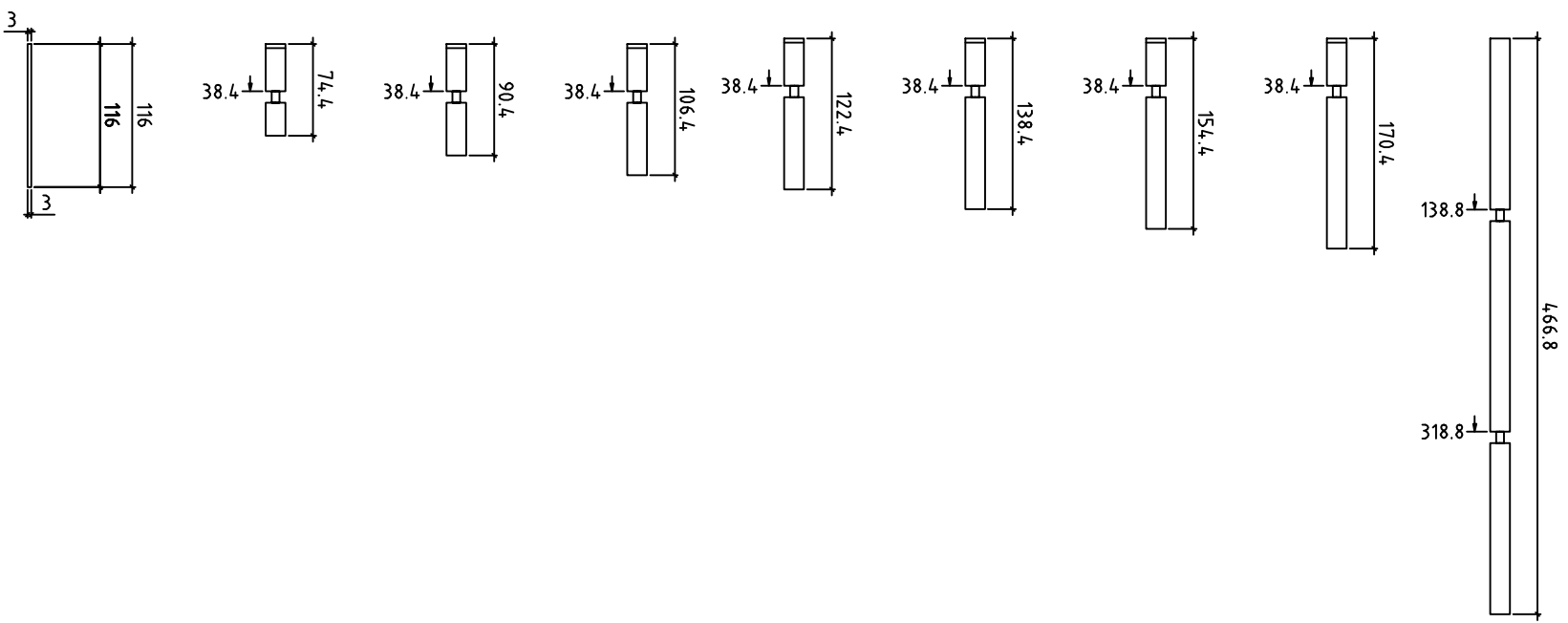

Kood	Materjal	9.2x16	File	TSSMONDO.dwg	Leht	16/23
123 /1						
124 /2						
125 /2						
126 /2						
127 /2						
128 /2						
129 /2						
130 /2						
131 /5						



BEARING BAR

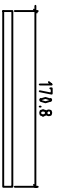

1 / 17  
4.5x9

Ground frame

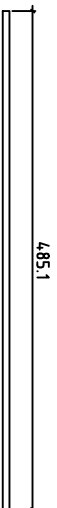

GF3 / 2  
14x7

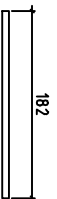

GF6 / 1  
14x7

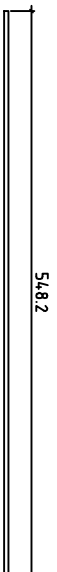

GF1 / 2  
14x7

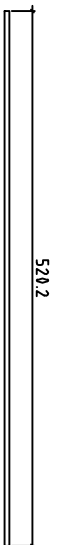

GF2 / 3  
14x7

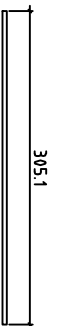

GF4 / 2  
14x7

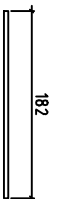

GF9 / 1  
14x7

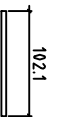

GF5 / 2  
14x7

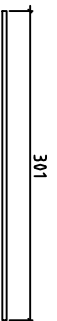

GF8 / 2  
9x4.4

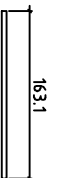

GF7 / 2  
9x4.4

Rafter

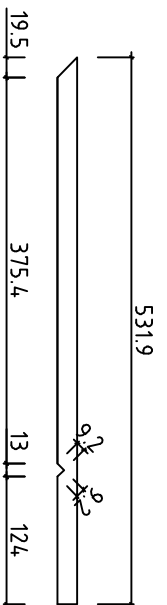

R1 / 36  
4.4x19.5

Kood	Materjal	File	Leht
		TSSMONDO.dwg	17/23

Collar beams

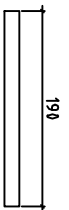

Cb1 /23  
4.5x14

FLOOR JOIST

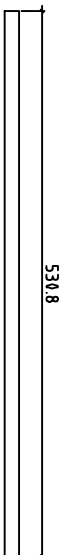

FJ1 /6  
4.5x14

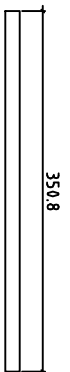

FJ4 /1  
4.5x14

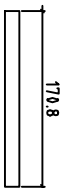

FJ3 /24  
4.5x14



FJ2 /9  
4.5x14

SUPPORT

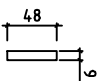

Sp1 /4  
9x4.5

Supporting post

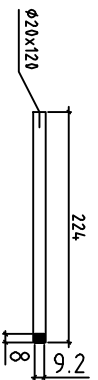

2 /2  
12x12

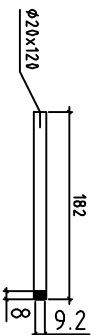

1 /2  
12x12

Balustrade



B15 /2  
9x19

Kood	Materjal	File	Leht
		TSSMONDO.dwg	18/23

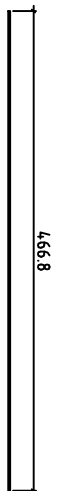

B14 / 2  
9x1.9

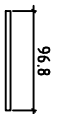

B12 / 25  
4.5x4.5



B11 / 2  
4.5x4.5

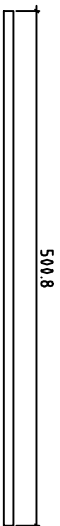

B16 / 1  
4.5x9.0

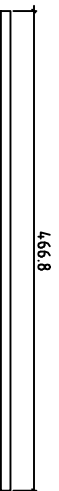

B13 / 1  
4.5x9.0

Kood

Materjal

File

TSSMONDO.dwg

Leht

19/23

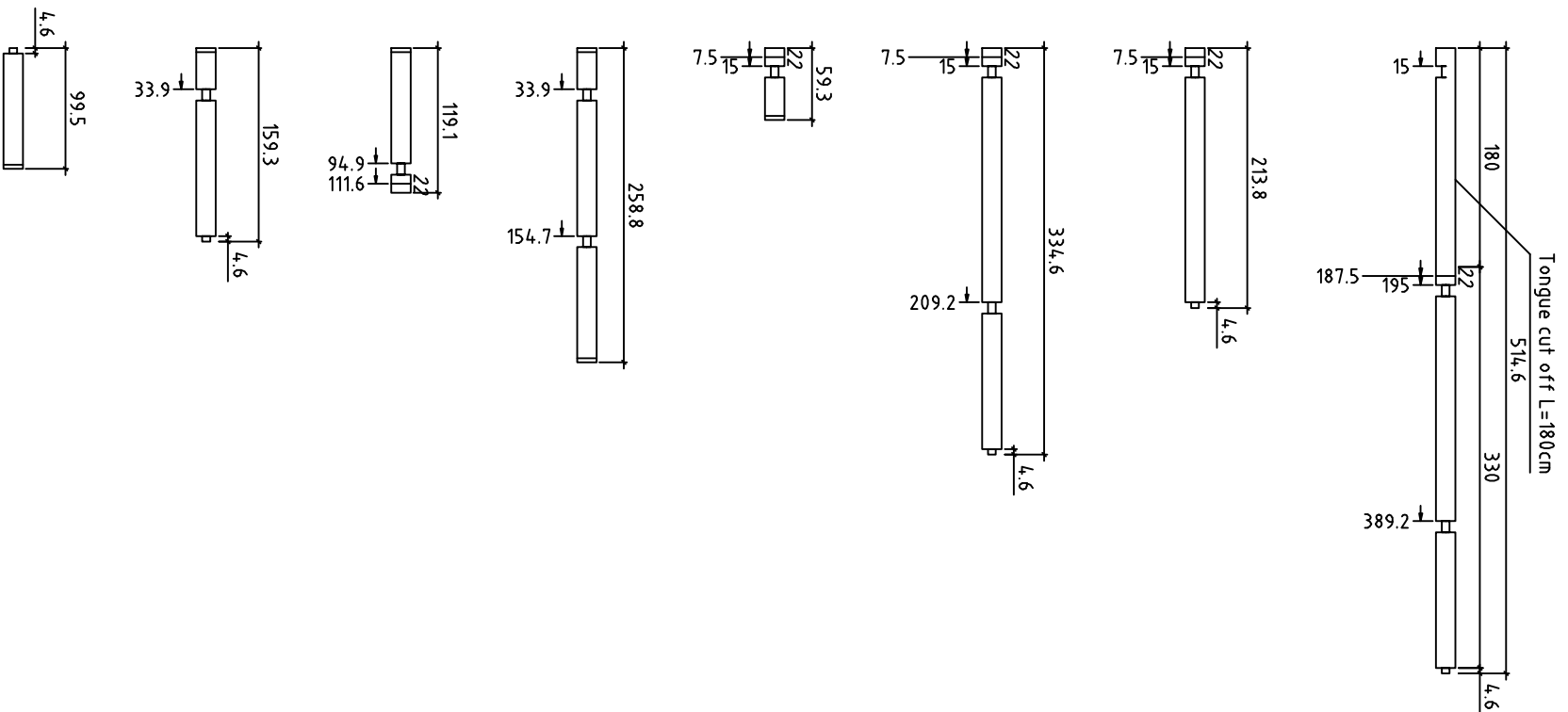

Kood

Materjal





9.2x16

File

TSSMONDO.dwg

Leht

2/23

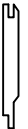
<p style="text-align: center;">Inside floor ground floor 8.8x2.8</p> <div style="text-align: center;">  </div> <p style="text-align: center;">           428.1 cm            421.4 cm            305.3 cm            192 cm            189.2 cm         </p> <p style="text-align: center;">           20 ps.            20 ps.            41 ps.            20 ps.            20 ps.         </p>					
<p style="text-align: center;">Inside floor second floor 8.8x2.8</p> <div style="text-align: center;">  </div> <p style="text-align: center;">           305.3 cm            231.7 cm         </p> <p style="text-align: center;">           102 ps.            20 ps.         </p>					
<p style="text-align: center;">Terrace board 9x2.8</p> <div style="text-align: center;">  </div> <p style="text-align: center;">170.3 cm</p> <p style="text-align: center;">118 ps.</p>					
<p style="text-align: center;">Roofboard 8.8x1.9</p> <div style="text-align: center;">  </div> <p style="text-align: center;">           563.2 cm            367 cm         </p> <p style="text-align: center;">           122 ps.            122 ps.         </p>					
<p style="text-align: center;">Black floor 10x2.2</p> <div style="text-align: center;">  </div> <p style="text-align: center;">           530.8 cm            350.8 cm            170.8 cm         </p> <p style="text-align: center;">           42 ps.            10 ps.            73 ps.         </p>					
<p style="text-align: center;">Ceiling board 8.8x1.2</p> <div style="text-align: center;">  </div> <p style="text-align: center;">305.3 cm</p> <p style="text-align: center;">156 ps.</p>					
<p>Kood</p>	<p>Material</p>	<p>File</p>	<p>TSSMONDO.dwg</p>	<p>Leht</p>	<p>20/23</p>



Baseboard 1.9x9

26.36 run.m.

Skirting slat 1.9x3.5



113.62 run.m.

Roof decor 1.9x12 1.9x12



Total  
367 cm  
551.2 cm  
563.2 cm

81.3 run.m.  
4 ps.  
8 ps.  
4 ps.

Roof decor 3.0x3.0



Total  
531.2 cm

21.25 run.m.  
4 ps.

Kood

Materjal

File

TSSMONDO.dwg

Leht

21/23

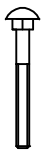

Bolt M10x200  
Bolt M10x120  
Bolt M10x150

18 ps.  
78 ps.  
102 ps.



Disk M10  
Total

198 ps.

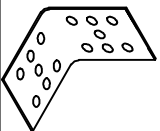

Fixing corner 90x90x4.0  
Total

64 ps.



Fixing plate 50x50  
Total

13 ps.



Nut M10  
Total

198 pcs

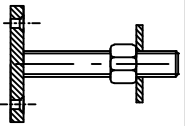

SUPPORT M20  
Total

4 pcs.

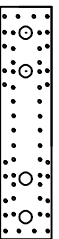

Fixing plate 90x180  
Total

36 pcs.

StudØ M12  
Stud1 ØM12x3310  
Stud2 ØM12x5000  
Stud3 ØM12x2750  
Stud4, ØM12x3230

4 pcs.  
4 pcs.  
1 pc.  
2 pcs.

Kood

Materjal

File

T5SMONDO.dwg

Leht

22/23

Doors & windows

	<p>880x2020</p>	<p>1 pcs / 1-R</p>
 <p>880x2020</p> <p>2 pc/ 1-R 1-L</p>	<p>700x2020</p>	<p>2 pcs / 2-R</p>
	<p>1100x1160</p>	<p>5 pcs/ 3-L 2-R</p>
	<p>880x1030</p>	<p>1 pc/ 1-R</p>
	<p>580x870</p>	<p>1 pc/ 1-R</p>

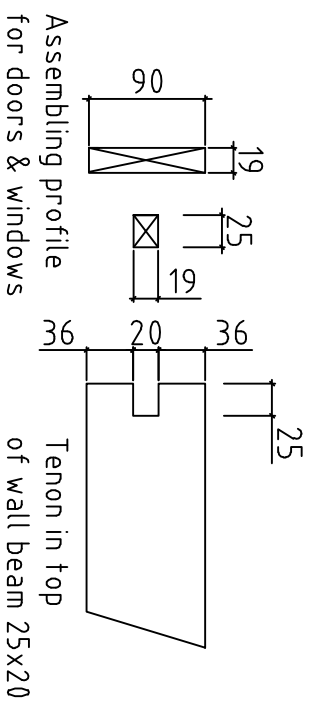
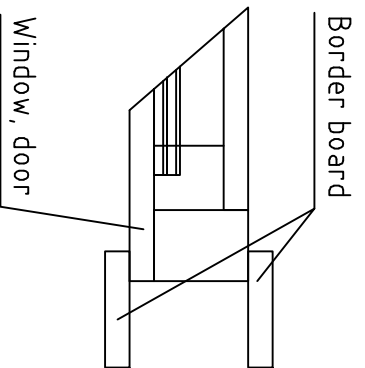



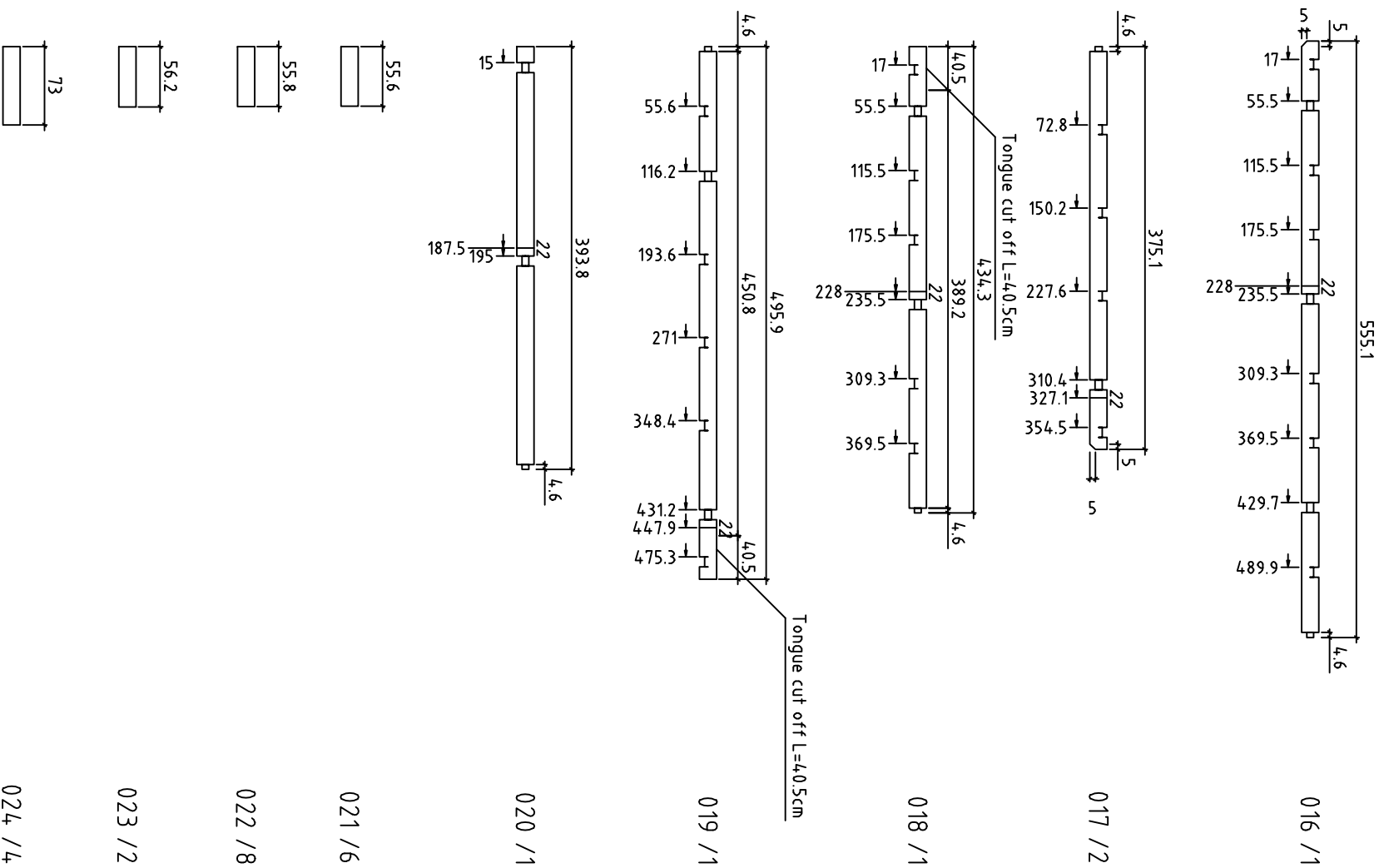

Kood	Materjal	File	Leht
	9.2x16	TSSMONDO.dwg	3/23

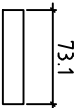

025 /2

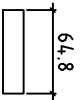

026 /2

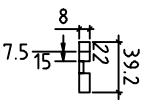

027 /2

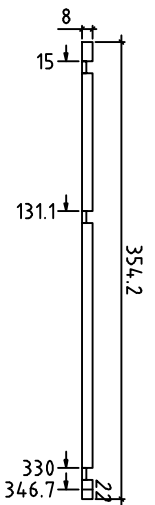

028 /1

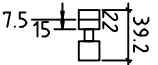

029 /84

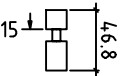

030 /1

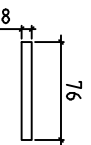

031 /2

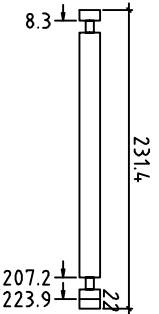

032 /1

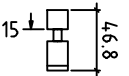

033 /12

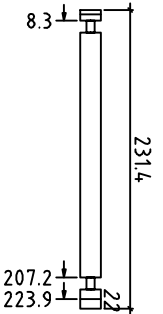

034 /12

Kood	Materjal	9.2x16	File	TSSMONDO.dwg	Leht	4/23
------	----------	--------	------	--------------	------	------

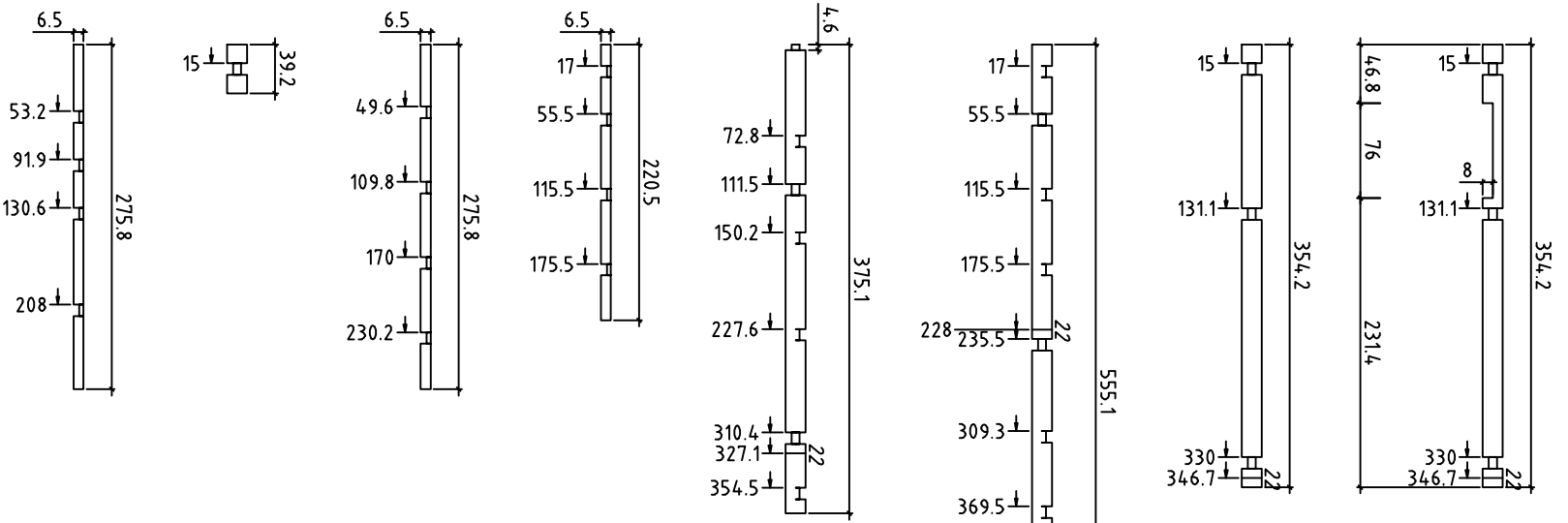

Kood

Materjal

9.2x16

File

TSSMONDO.dwg

Leht

5/23

042 / 2

041 / 68

040 / 2

039 / 2

038 / 1

037 / 2

036 / 1

035 / 1

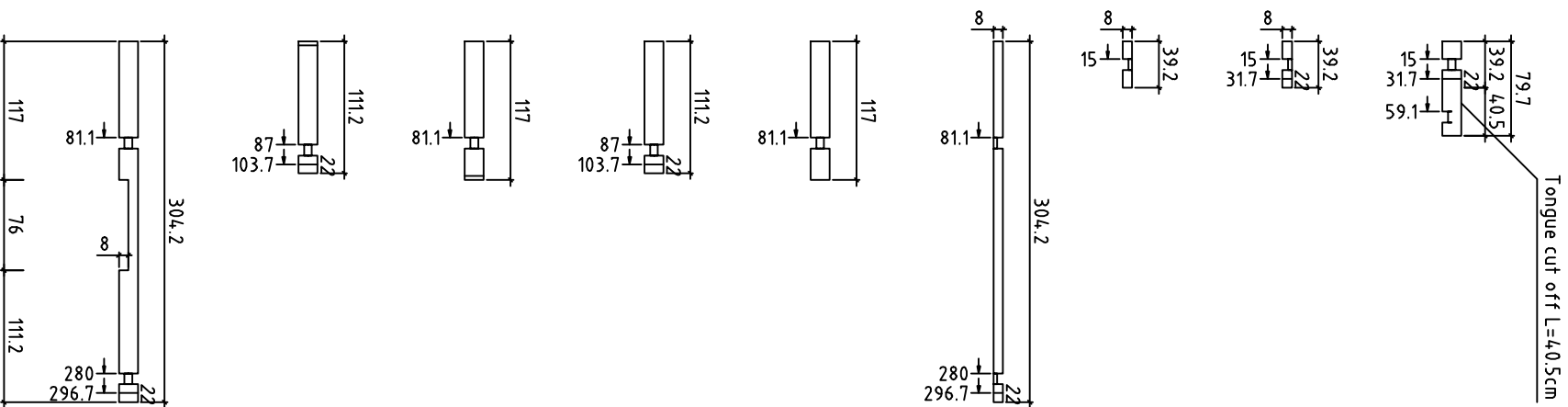

Tongue cut off L=40.5cm

043 / 2

044 / 4

045 / 5

046 / 1

047 / 1

048 / 1

049 / 12

050 / 12

051 / 1

Kood

Material

9.2x16

File

TSSMONDO.dwg

Leht

6/23

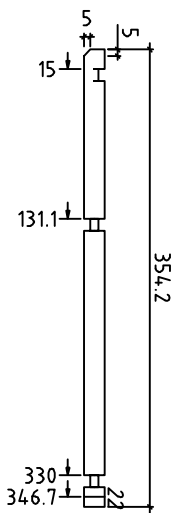

052 / 1

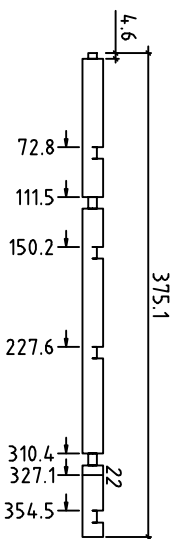

053 / 1

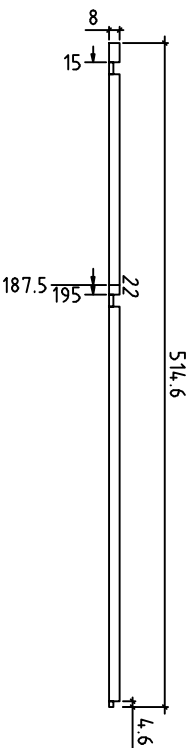

054 / 1

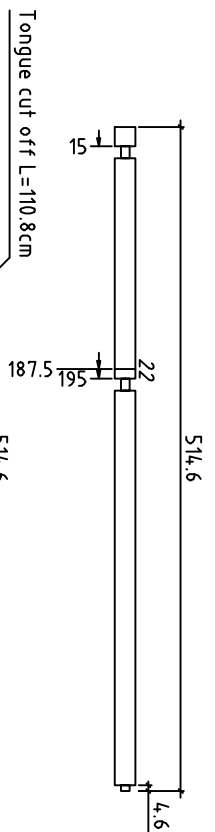

055 / 3

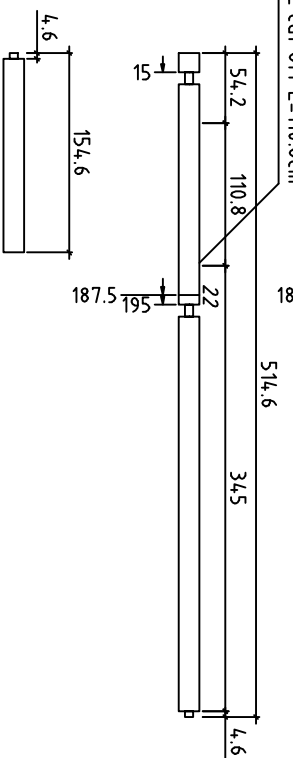

055A / 1

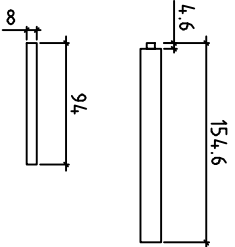

056 / 1

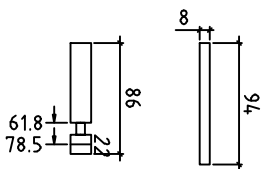

057 / 1

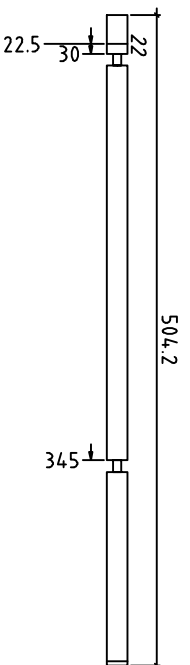

059 / 1

Kood	Materjal	File	Leht
	9.2x16	TSSMONDO.dwg	7/23

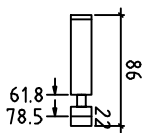

060 /12

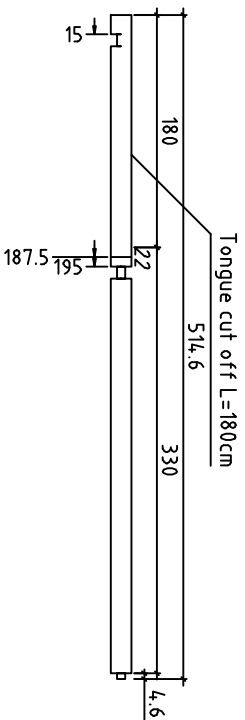

061 /1

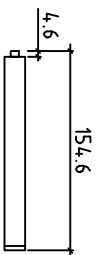

062 /1

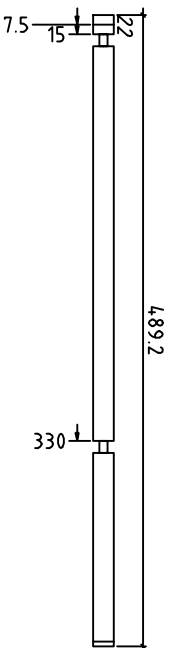

063 /3

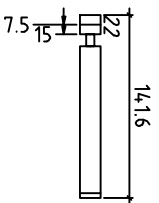

064 /8

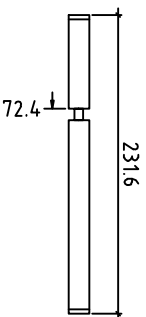

065 /7

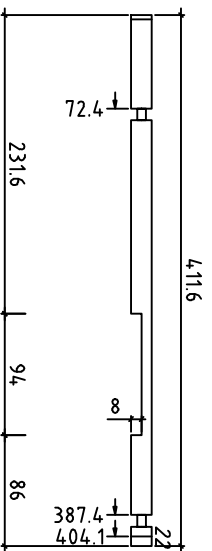

066 /1

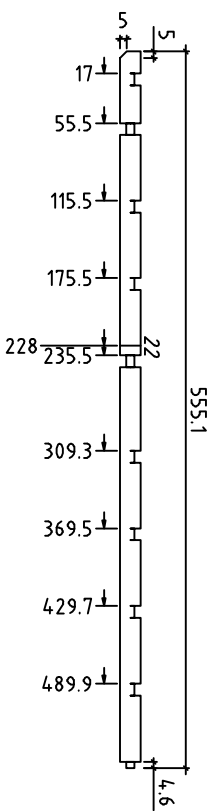

067 /1

Kood	Materjal	9.2x16	File	TSSMONDO.dwg	Leht	8/23
------	----------	--------	------	--------------	------	------

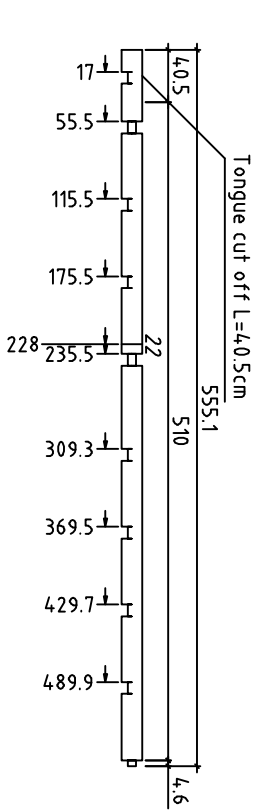

068 /1

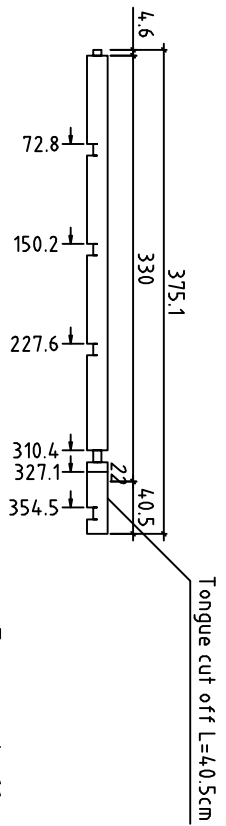

069 /1

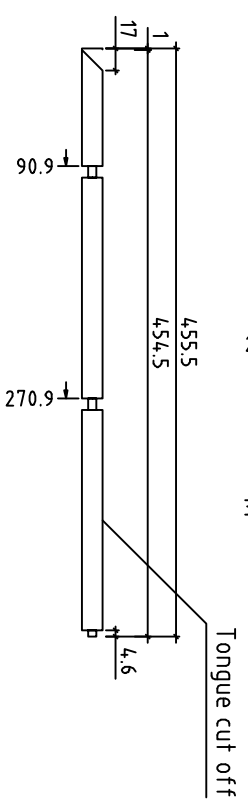

070 /11

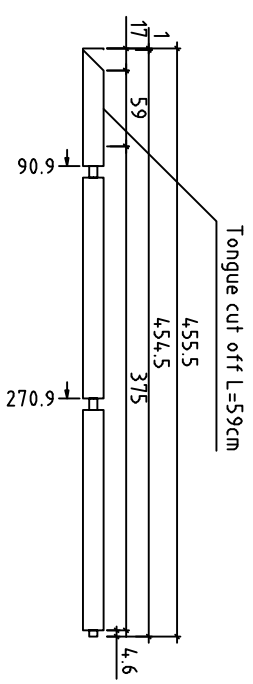

070A /2

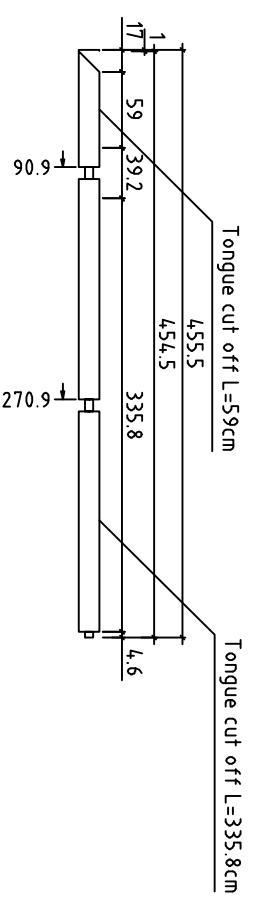

070B /1

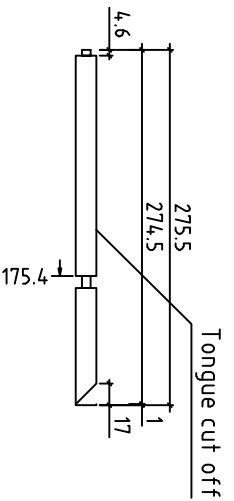

071 /10

Kood	Material	9.2x16	File	TSSMONDO.dwg	Leht	9/23
------	----------	--------	------	--------------	------	------

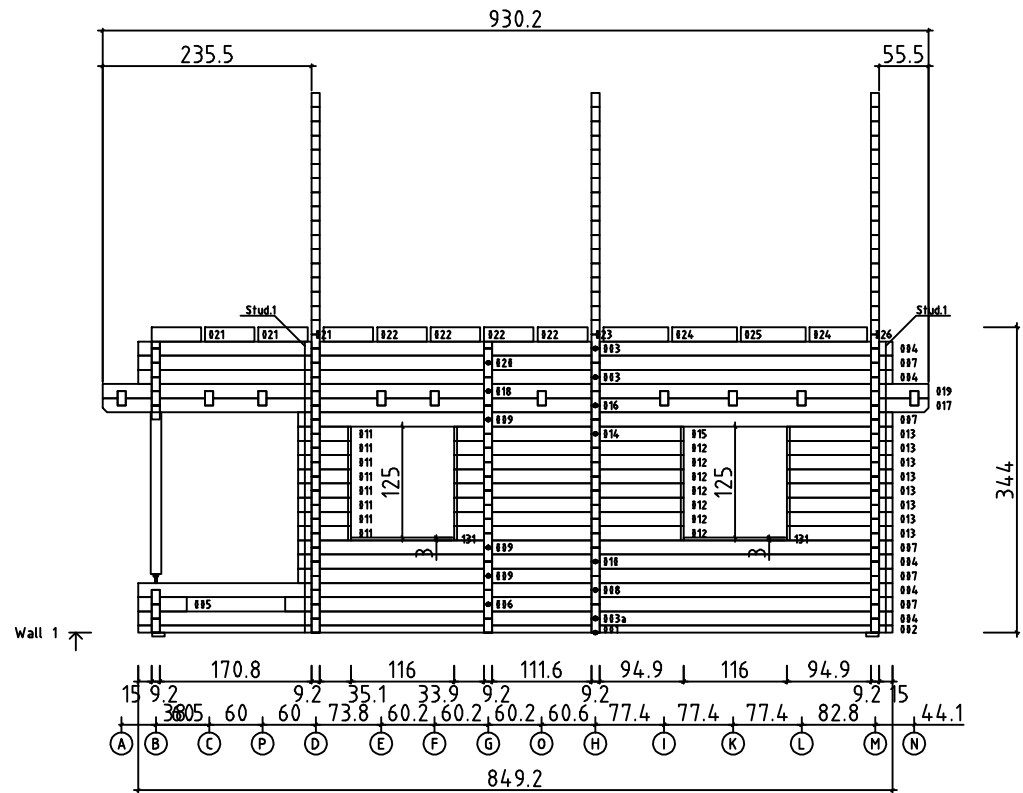

Code	Page 18	06.04.10.
Drawing WALL 1	Scale 1:50	
AS ASTEL	File T55M0NDD.dwg	



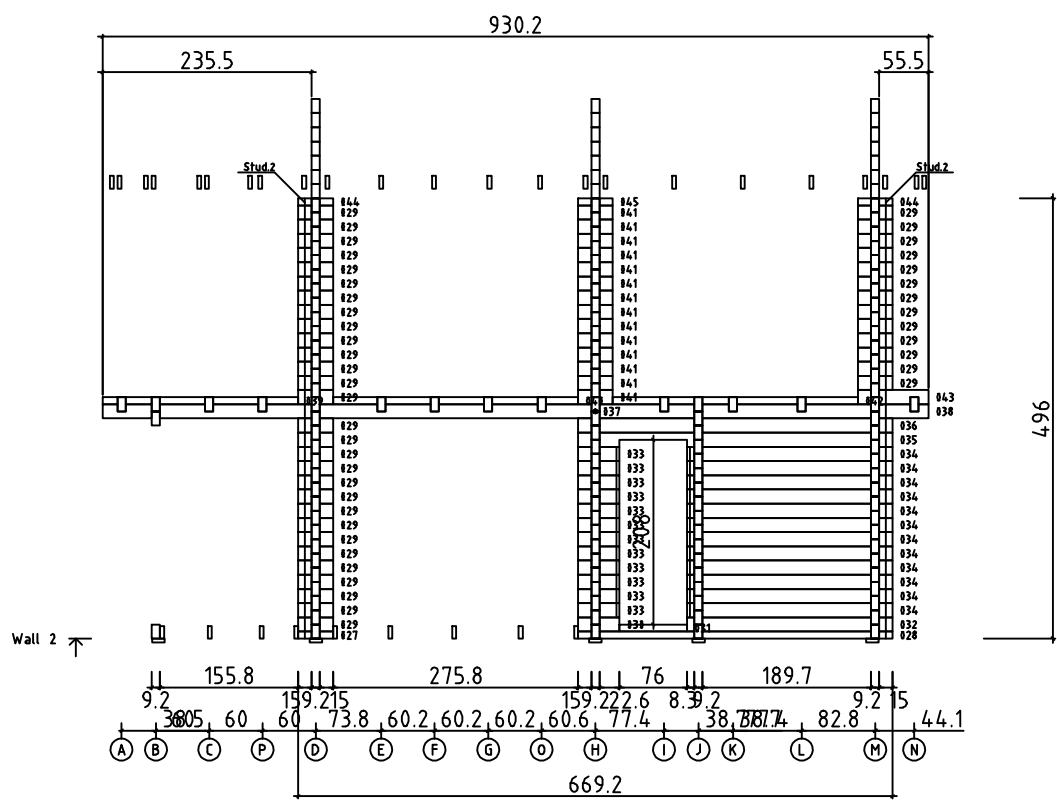

Code	Page 19	06.04.10.
Drawing WALL 2	Scale 1:50	
AS ASTEL	File T55M0NDD.dwg	

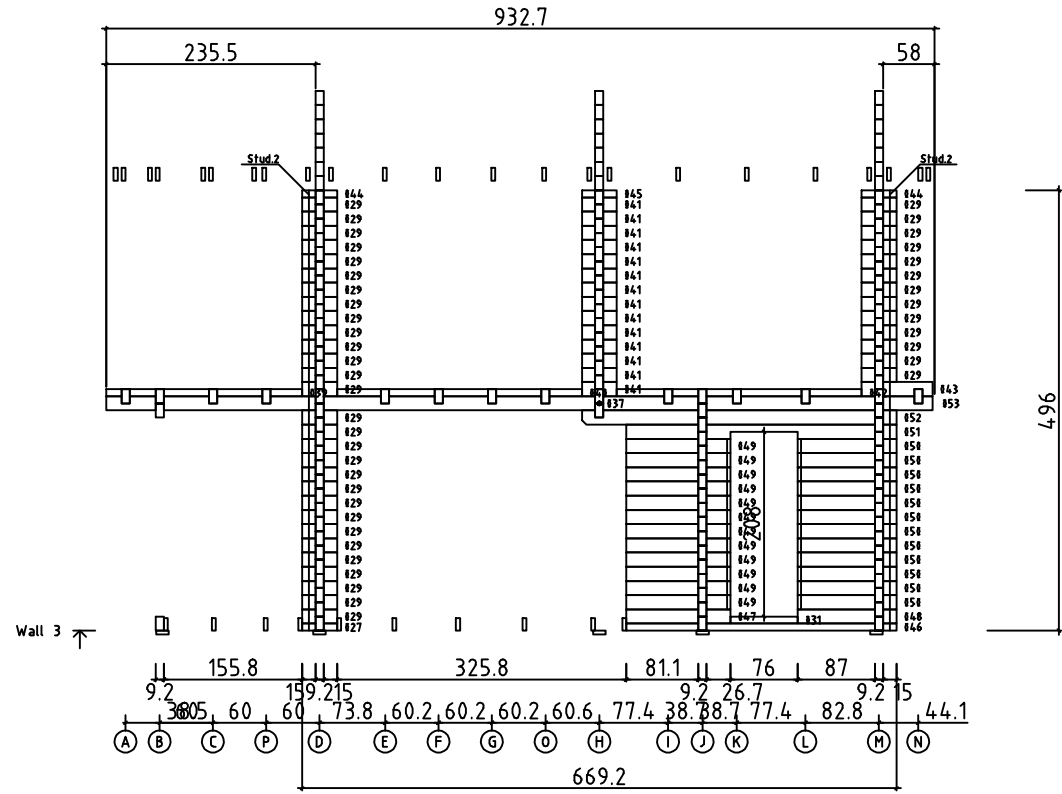

Code	Page 20	06.04.10.
Drawing WALL 3	Scale 1:50	
AS ASTEL	File T55M0NDD.dwg	

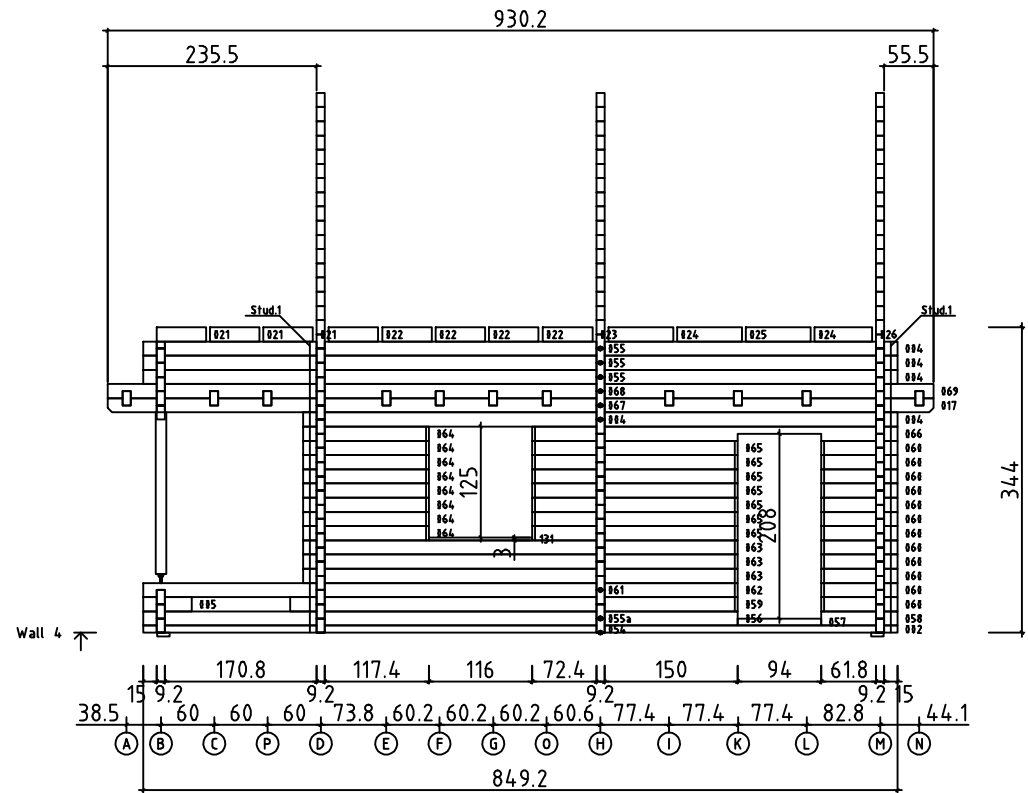

Code	Page 21	06.04.10.
Drawing WALL 4	Scale 1:50	
AS ASTEL	File T55M0ND0.dwg	

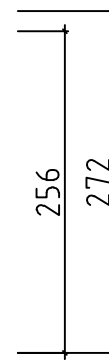
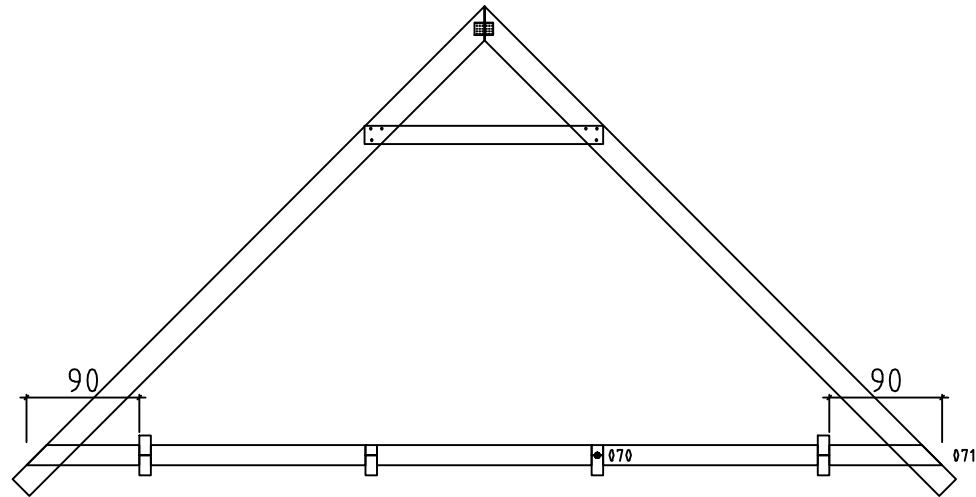

Wall A ↑

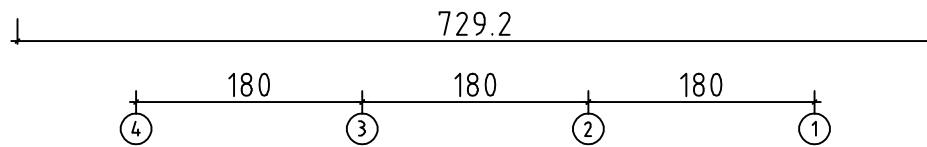

Code	Page 2	06.04.10.
Drawing WALL A	Scale 1:50	
AS ASTEL	File T55MONDO.dwg	

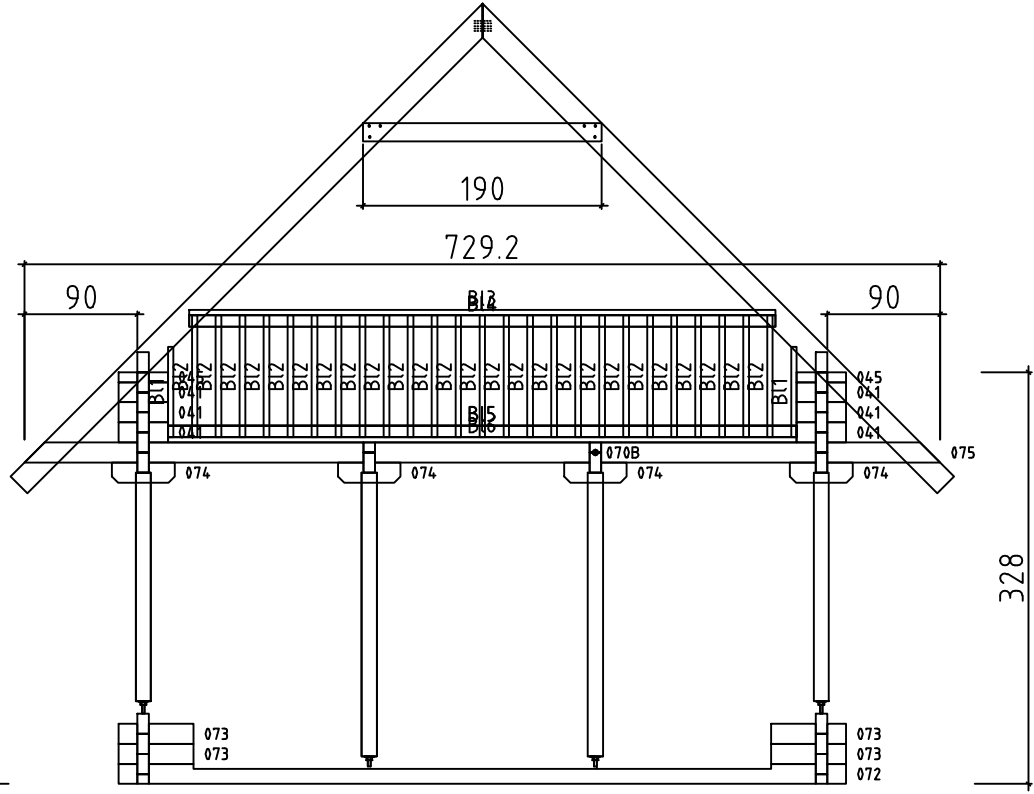

Wall B ↑

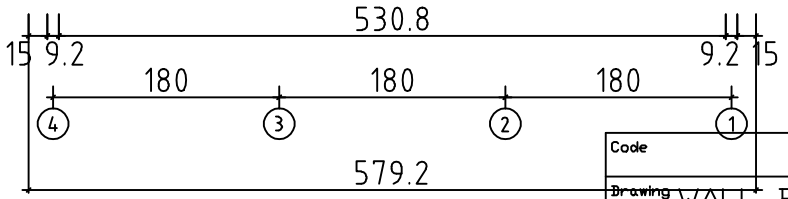

Code	Page 3	06.04.10.
Drawing WALL B	Scale 1:50	
AS ASTEL	File T55MONDO.dwg	

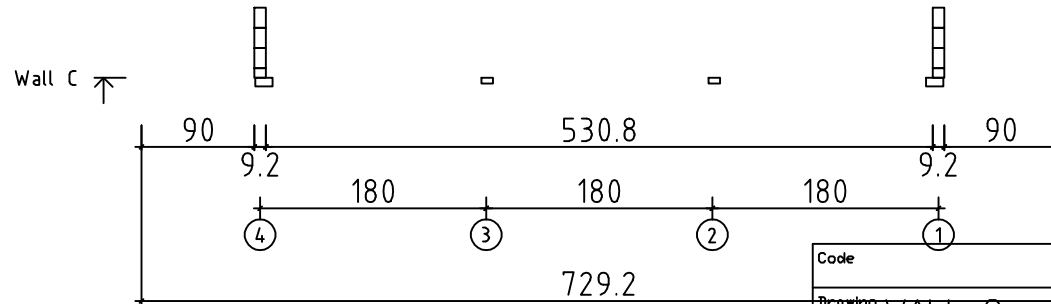
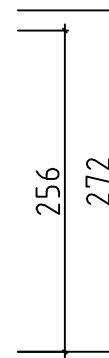
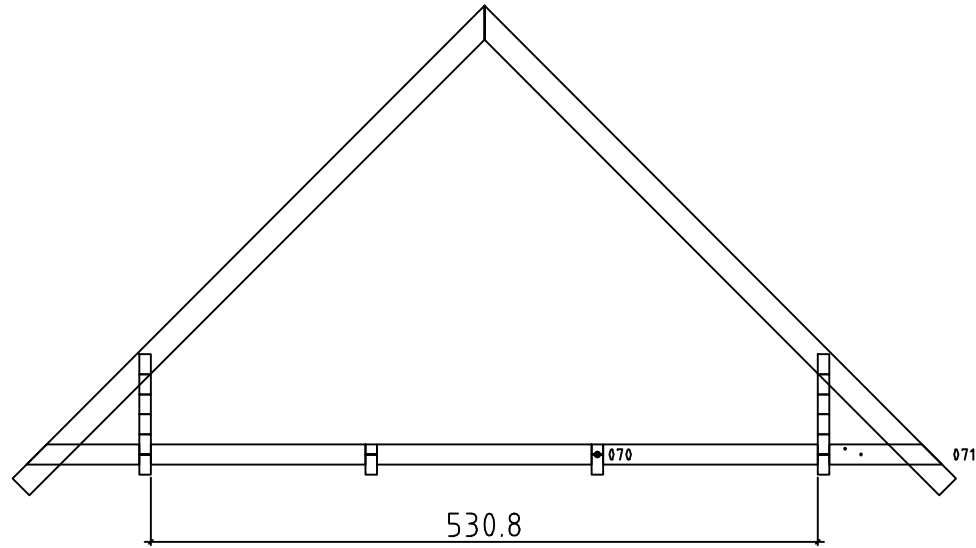

Code	Page 4	06.04.10.
Drawing WALL C	Scale 1:50	
AS ASTEL	File T55MONDO.dwg	

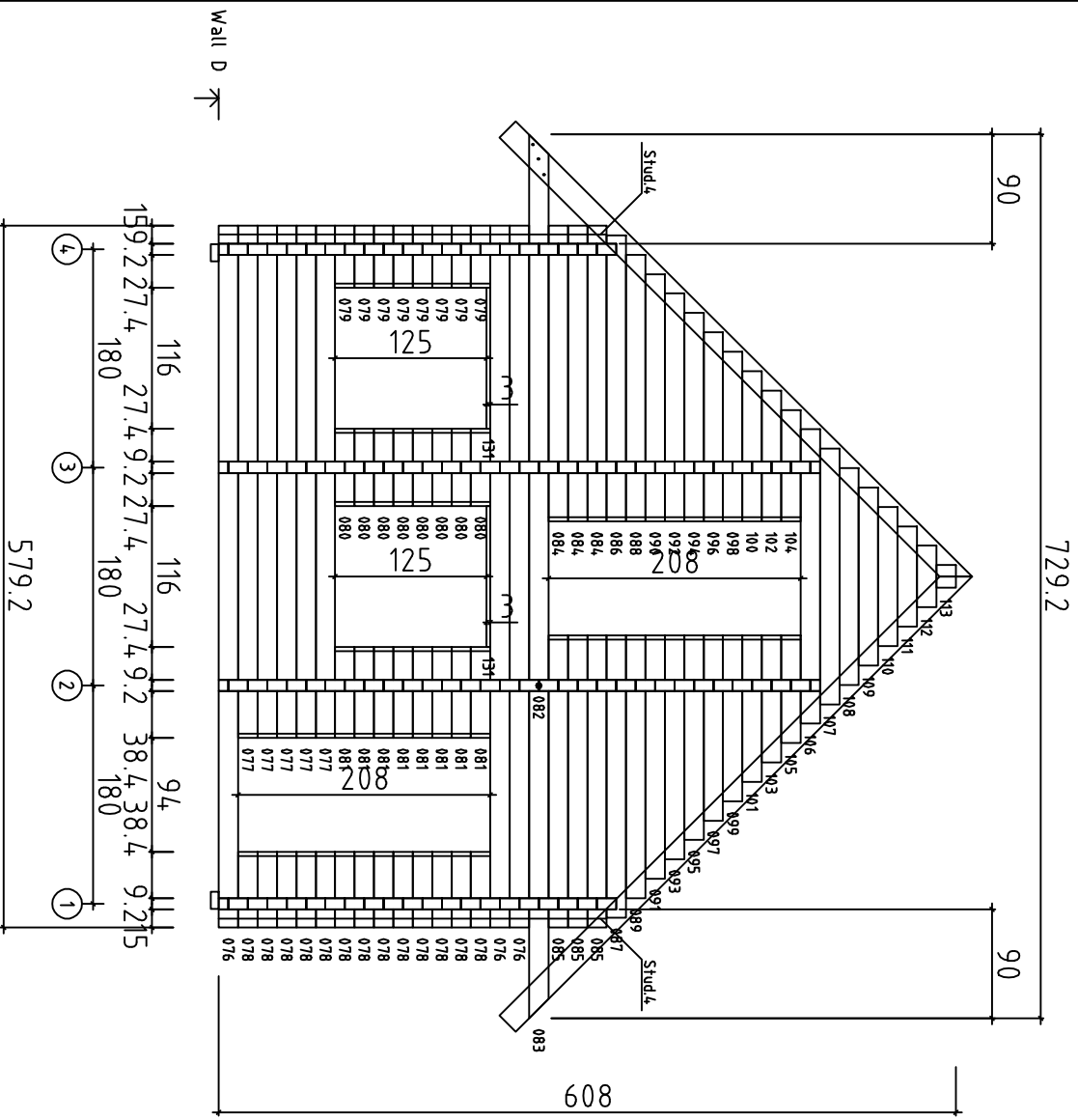

Code	Page 5	06.04.10.
Drawing WALL D		
AS A STEL		file TSSMONDD.dwg
		Scale 1:50

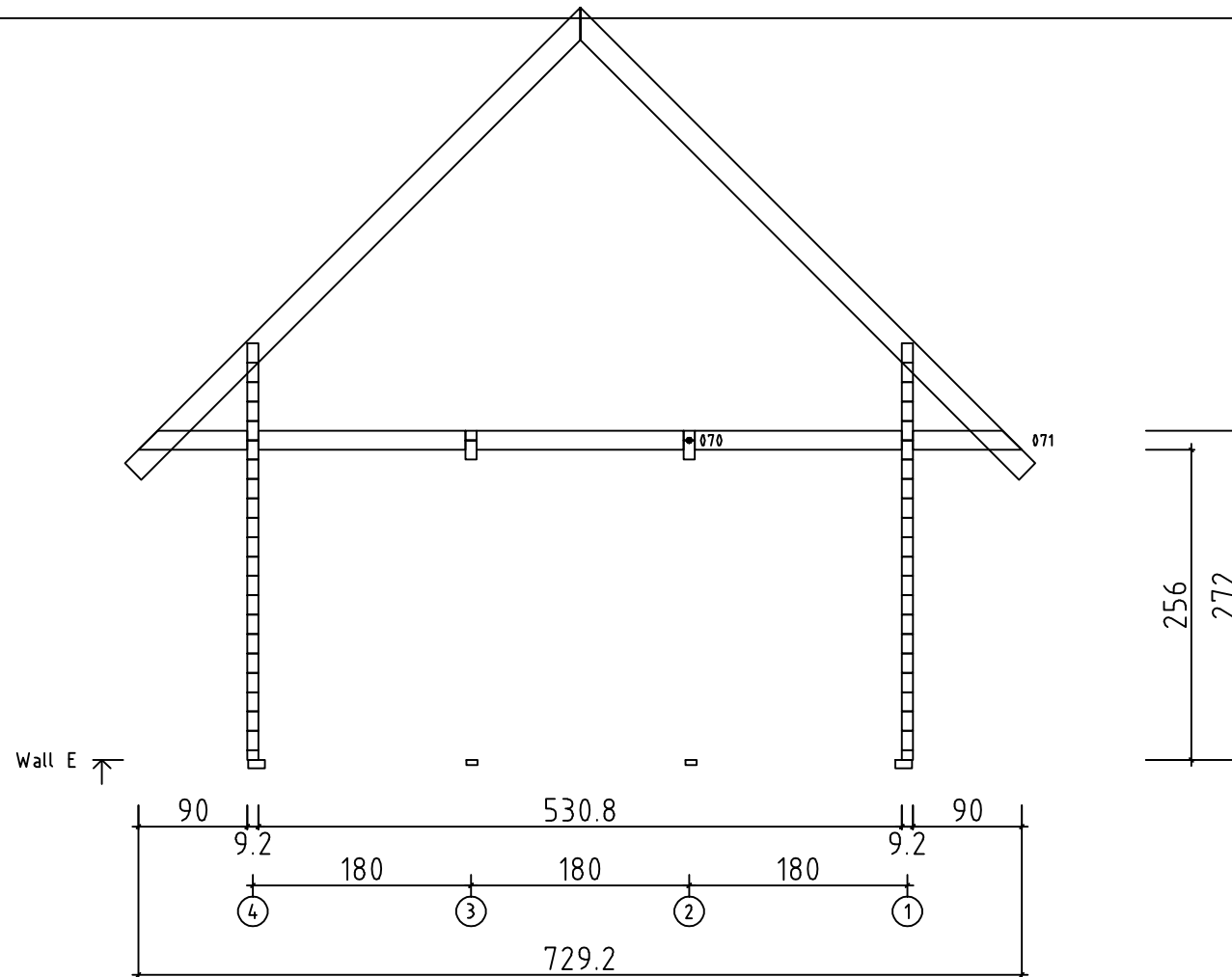

Code	Page 6	06.04.10.
Drawing WALL E	Scale 1:50	
AS ASTEL	File T55MONDO.dwg	



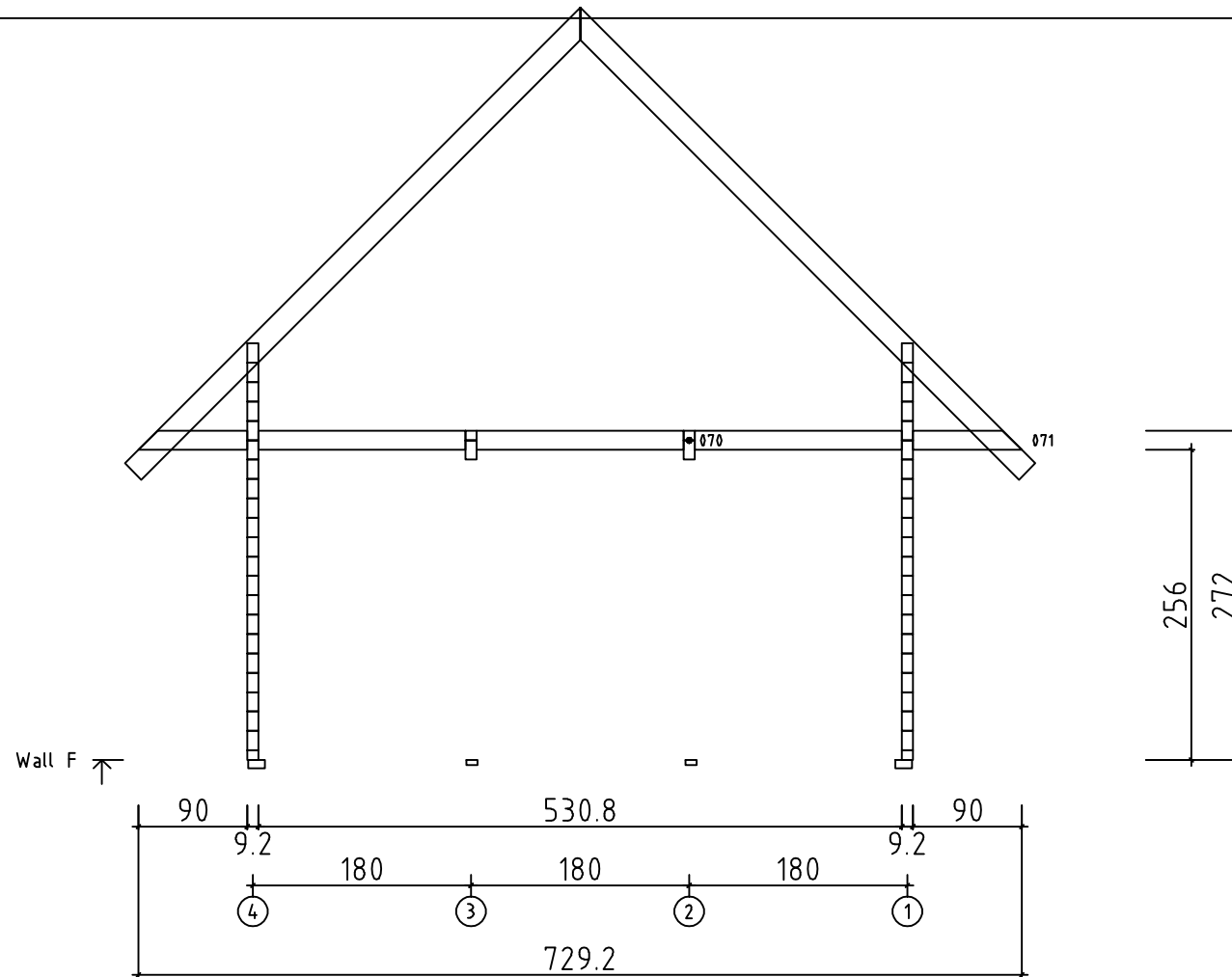

Code	Page 7	06.04.10.
Drawing WALL F		Scale 1:50
AS ASTEL	File T55MONDO.dwg	

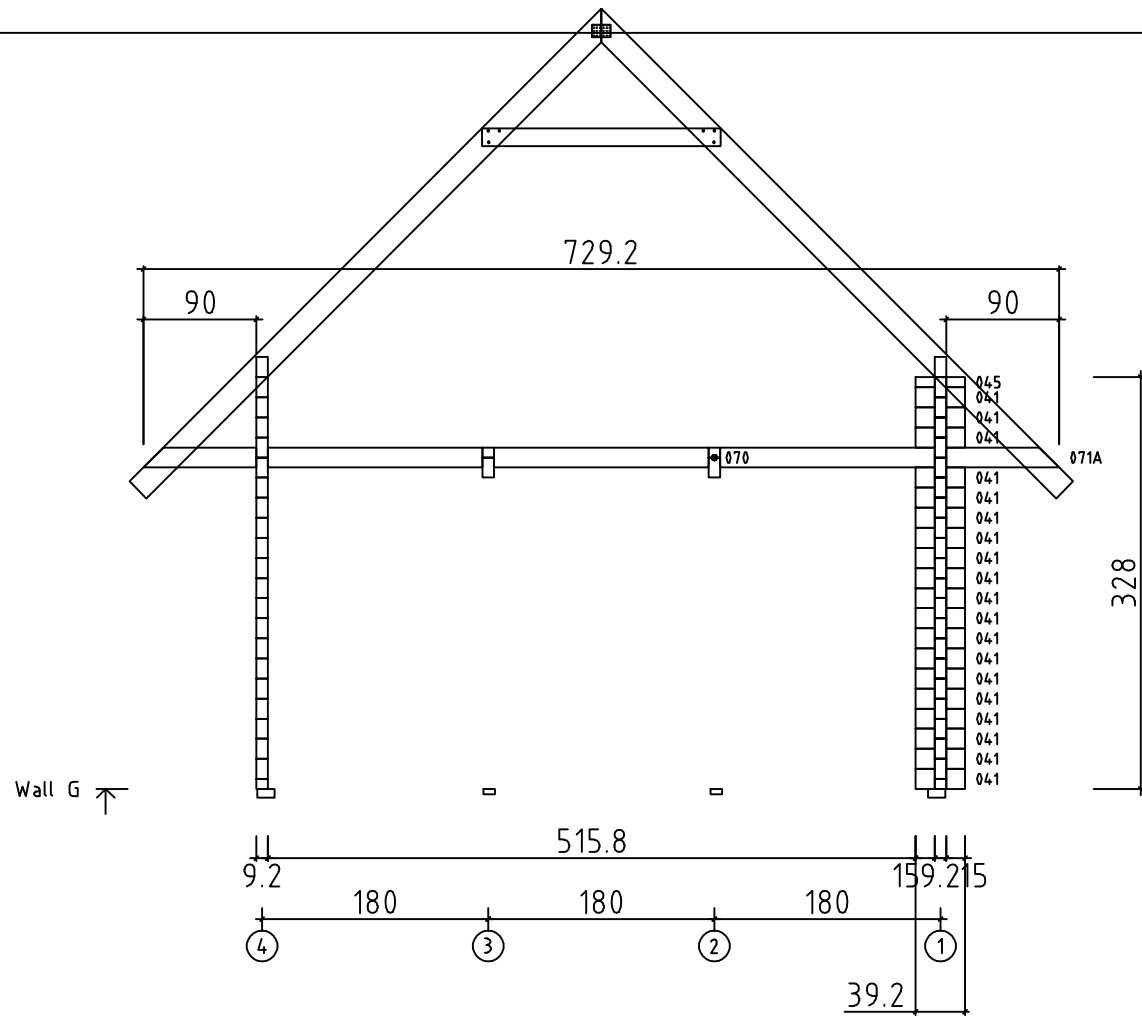

Code	Page 8	06.04.10.
Drawing WALL G	Scale 1:50	
AS ASTEL	File T55MONDO.dwg	

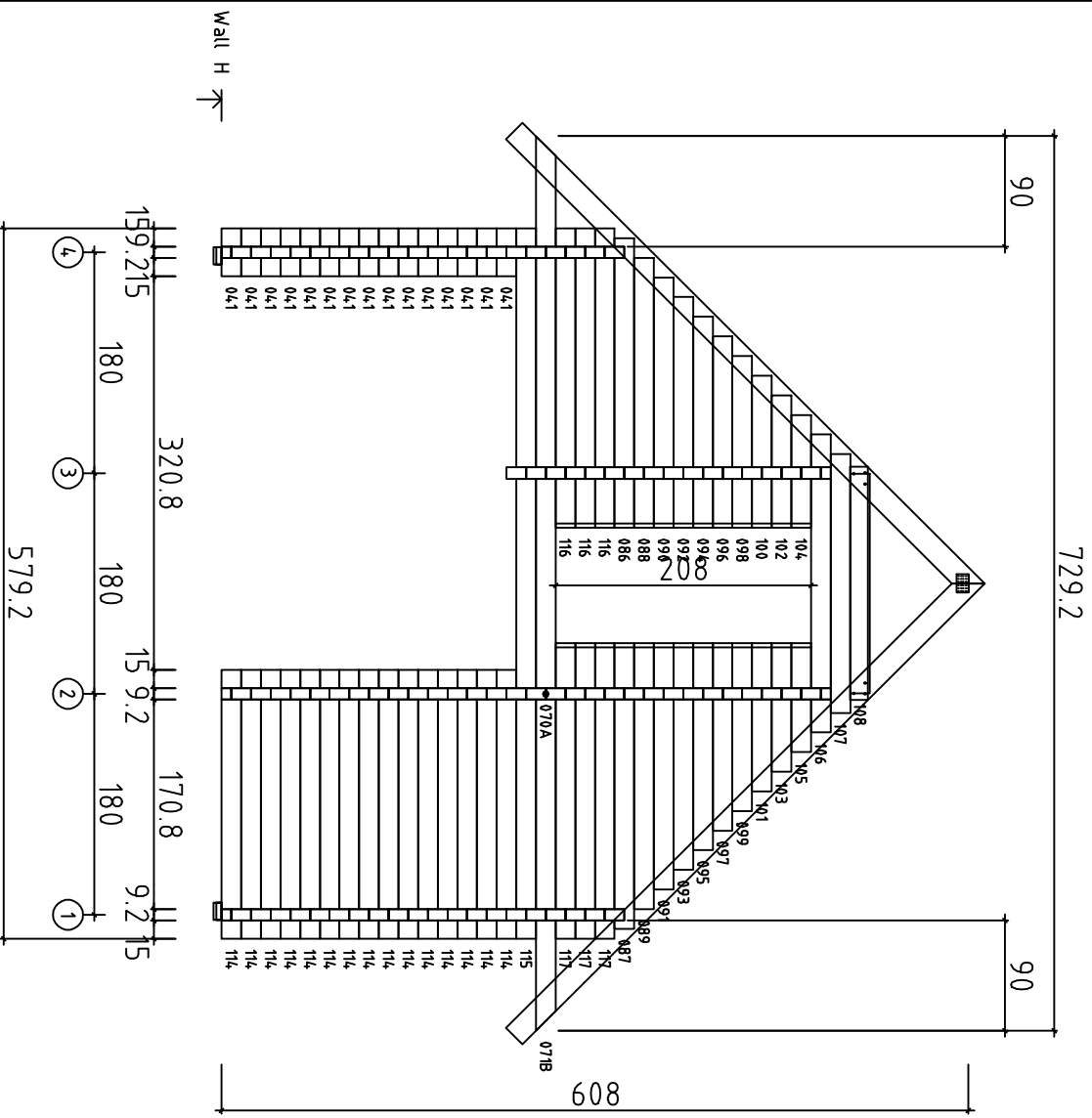

Wall H ←

Code	Page 9	06.04.10.
Drawing WALL H		Scale 1:50
AS A STEL		file TSSMONDD.dwg

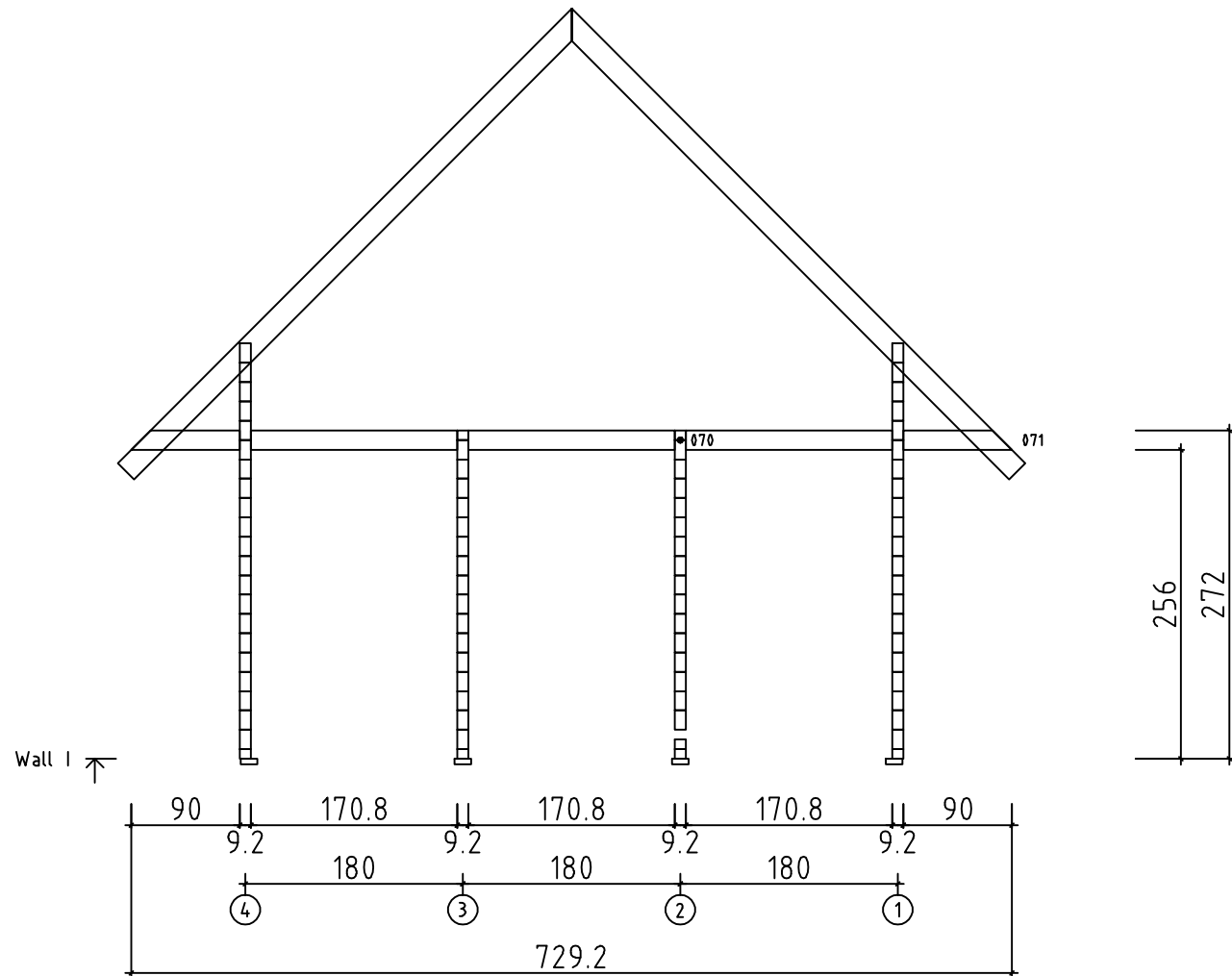

Code	Page 10	06.04.10.
Drawing WALL I	Scale 1:50	
AS ASTEL	File T55MONDO.dwg	

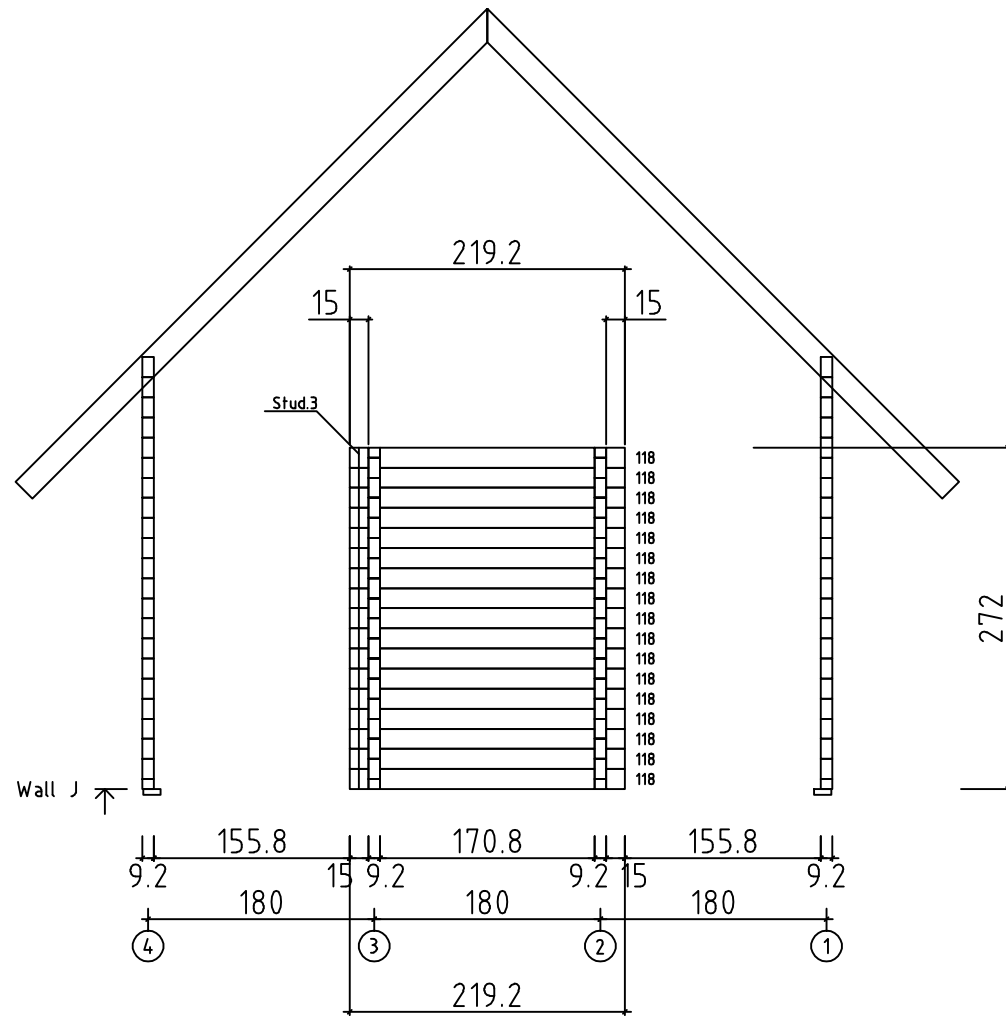

Code	Page 11	06.04.10.
Drawing WALL J	Scale 1:50	
AS ASTEL	File T55MONDO.dwg	

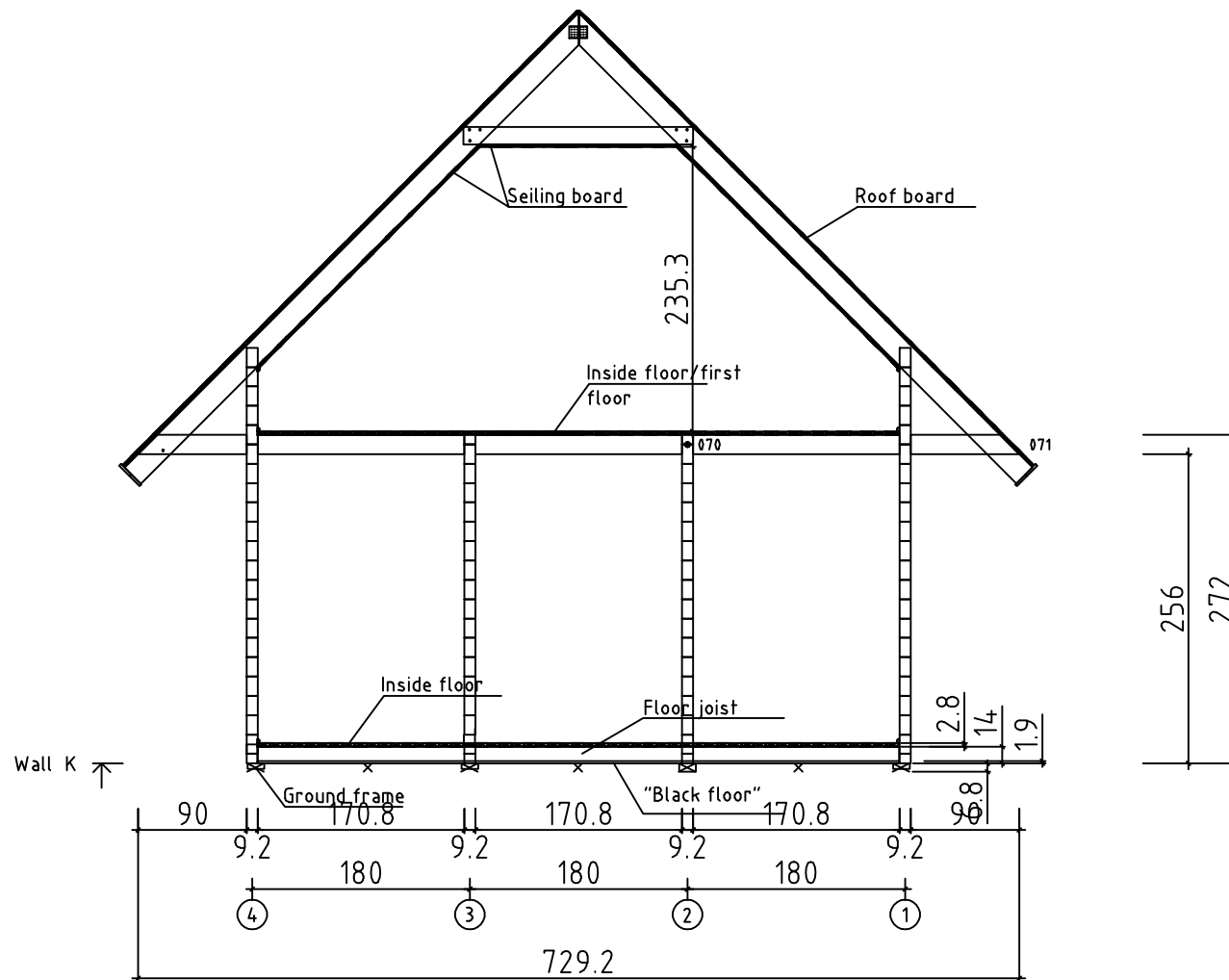

Code	Page 12	06.04.10.
Drawing WALL K	Scale 1:50	
AS ASTEL	File T55MONDO.dwg	

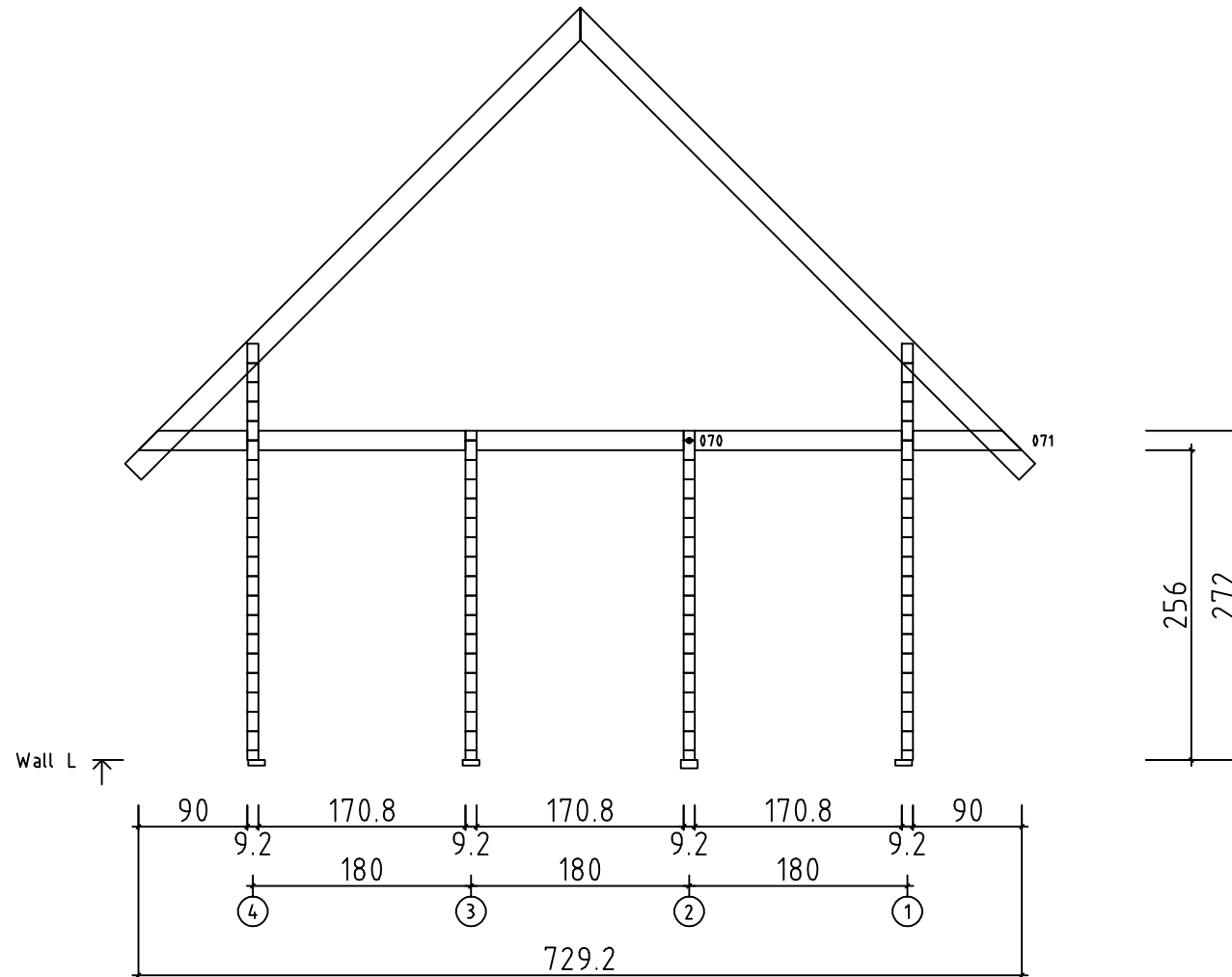

Code	Page 13	06.04.10.
Drawing WALL L	Scale 1:50	
AS ASTEL	File T55MONDO.dwg	

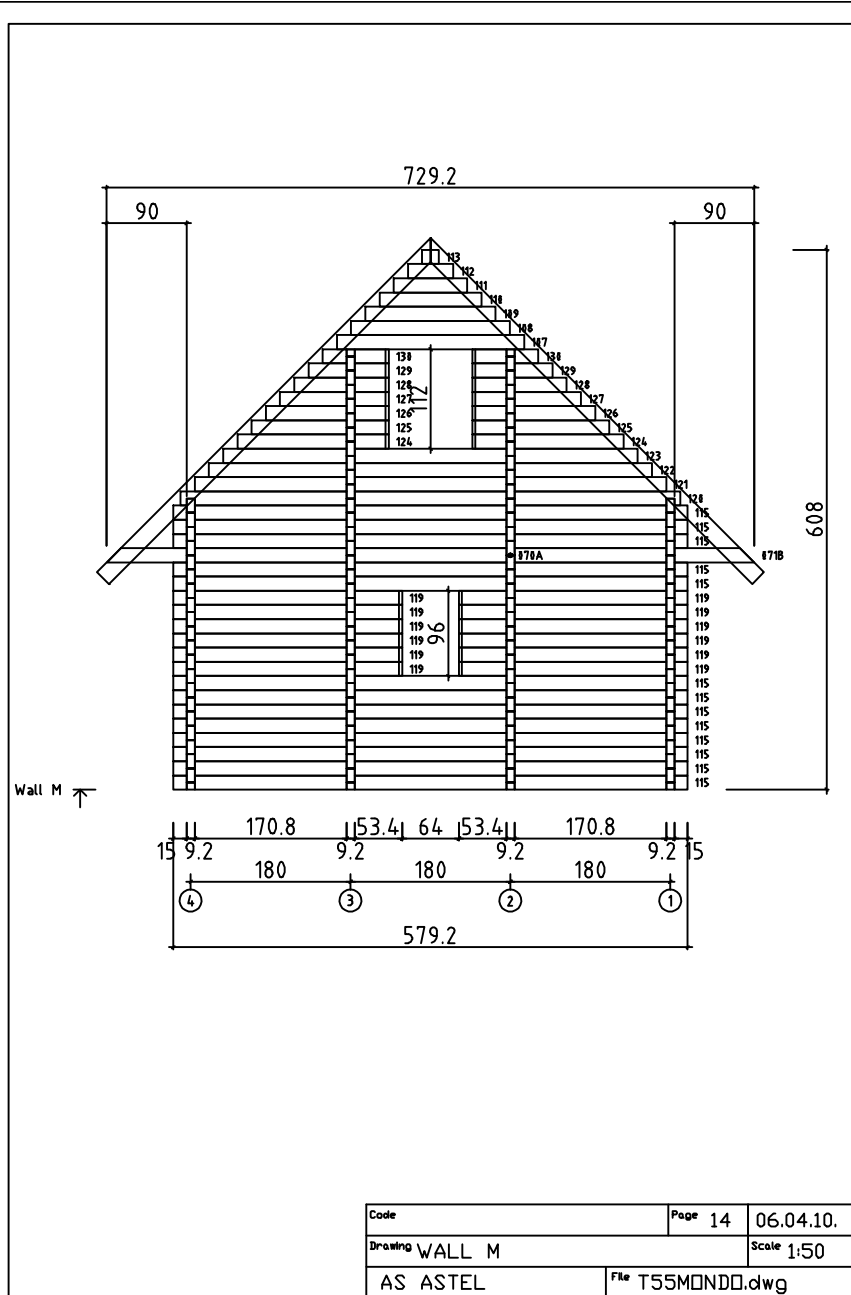

Code	Page 14	06.04.10.
Drawing WALL M	Scale 1:50	
AS ASTEL	File T55M0NDD.dwg	



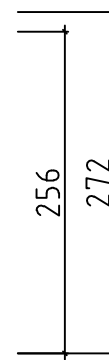
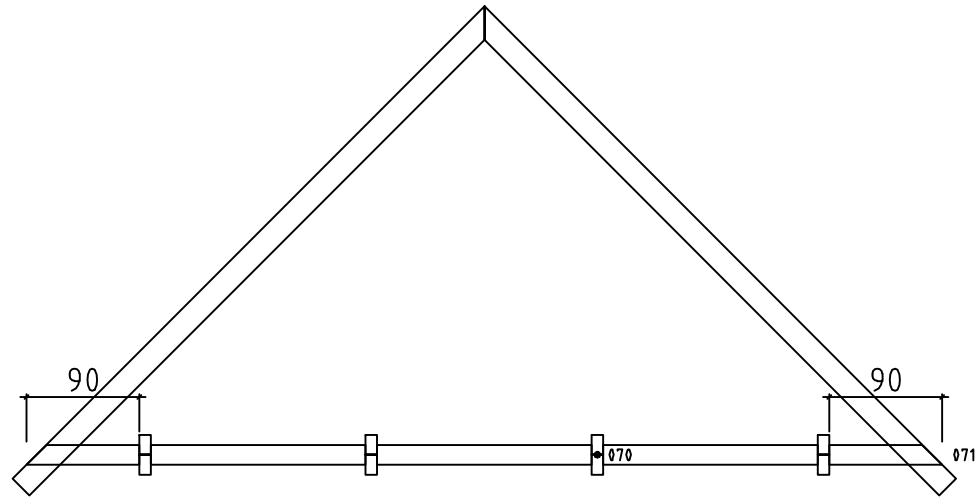

Wall N ↗

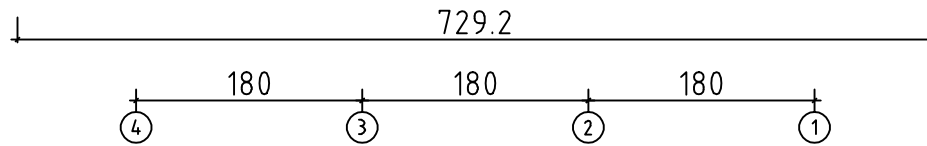

Code	Page 15	06.04.10.
Drawing WALL N	Scale 1:50	
AS ASTEL	File T55MONDO.dwg	

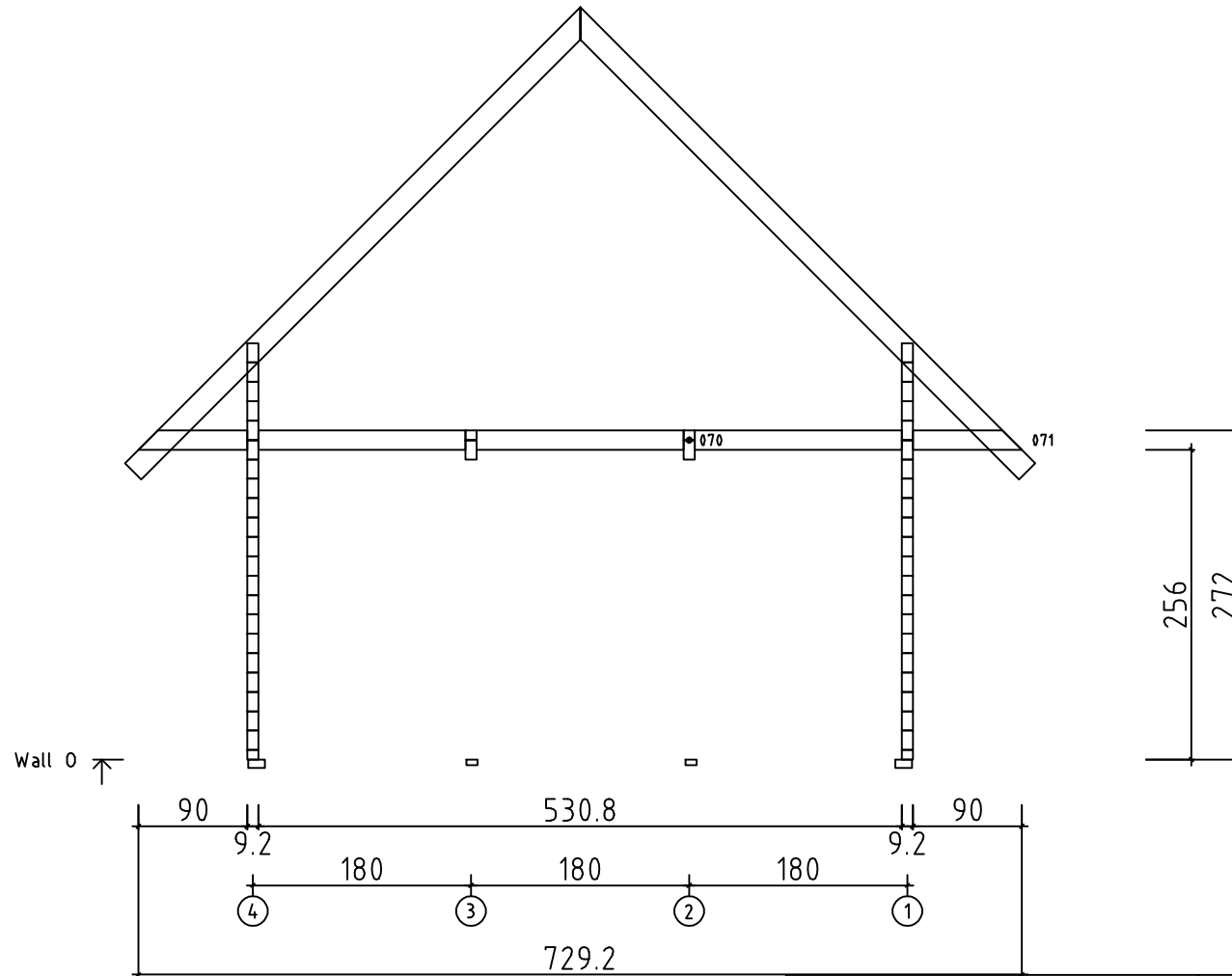

Code	Page 16	06.04.10.
Drawing WALL □	Scale 1:50	
AS ASTEL	File T55MONDO.dwg	

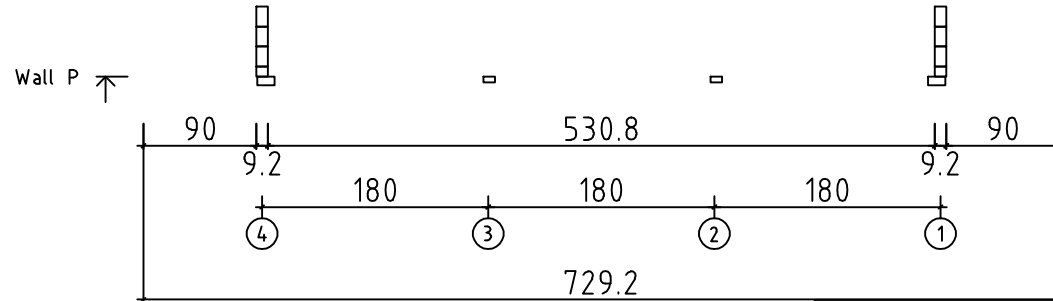
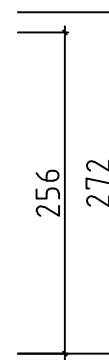
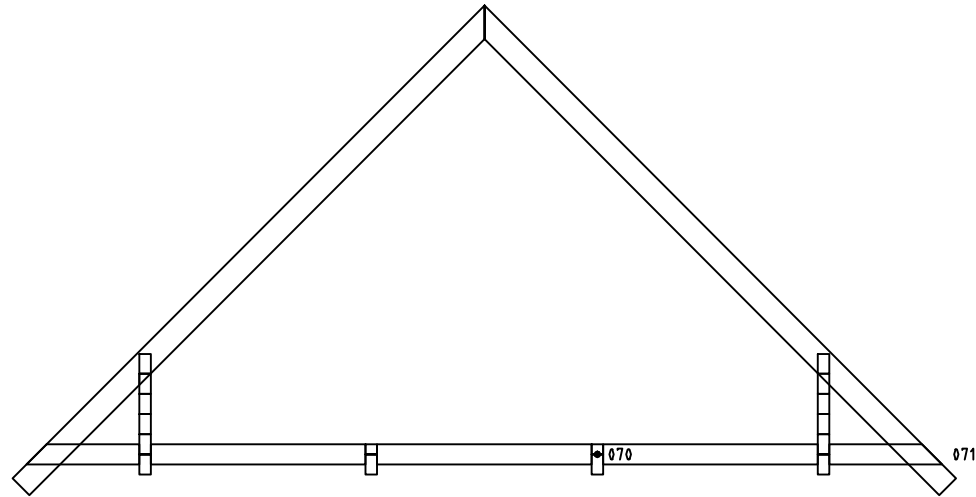

Code	Page 17	06.04.10.
Drawing WALL P	Scale 1:50	
AS ASTEL	File T55MONDO.dwg	